

Version 21 9th May 2020

AusINPA

Drawn by W.Mason

Email: 4d.cnc.art@gmail.com

on behalf of Robert Luttrell

<http://bobthebeeman.com.au/>

May 2020

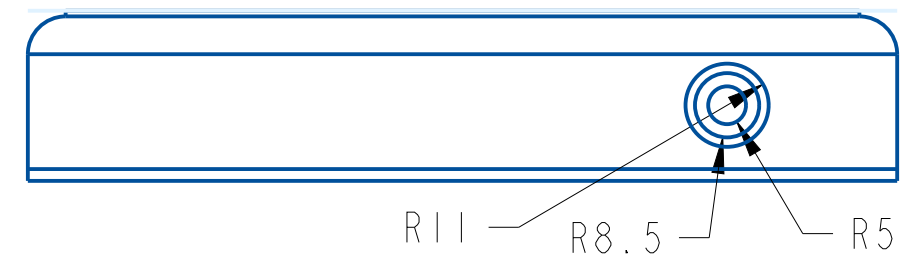
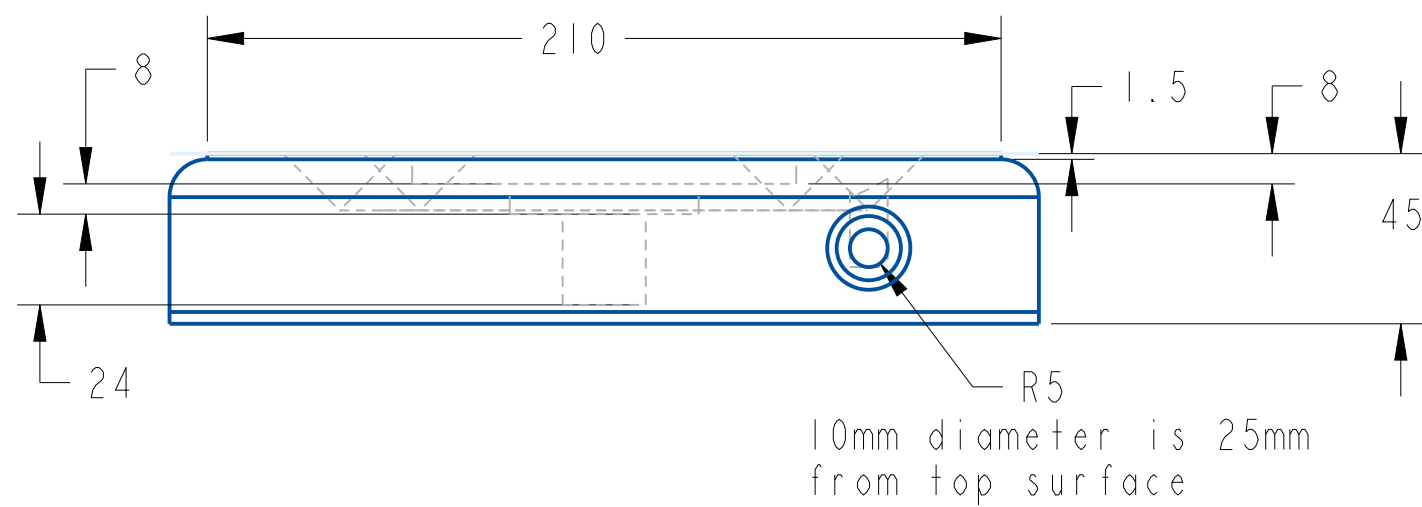
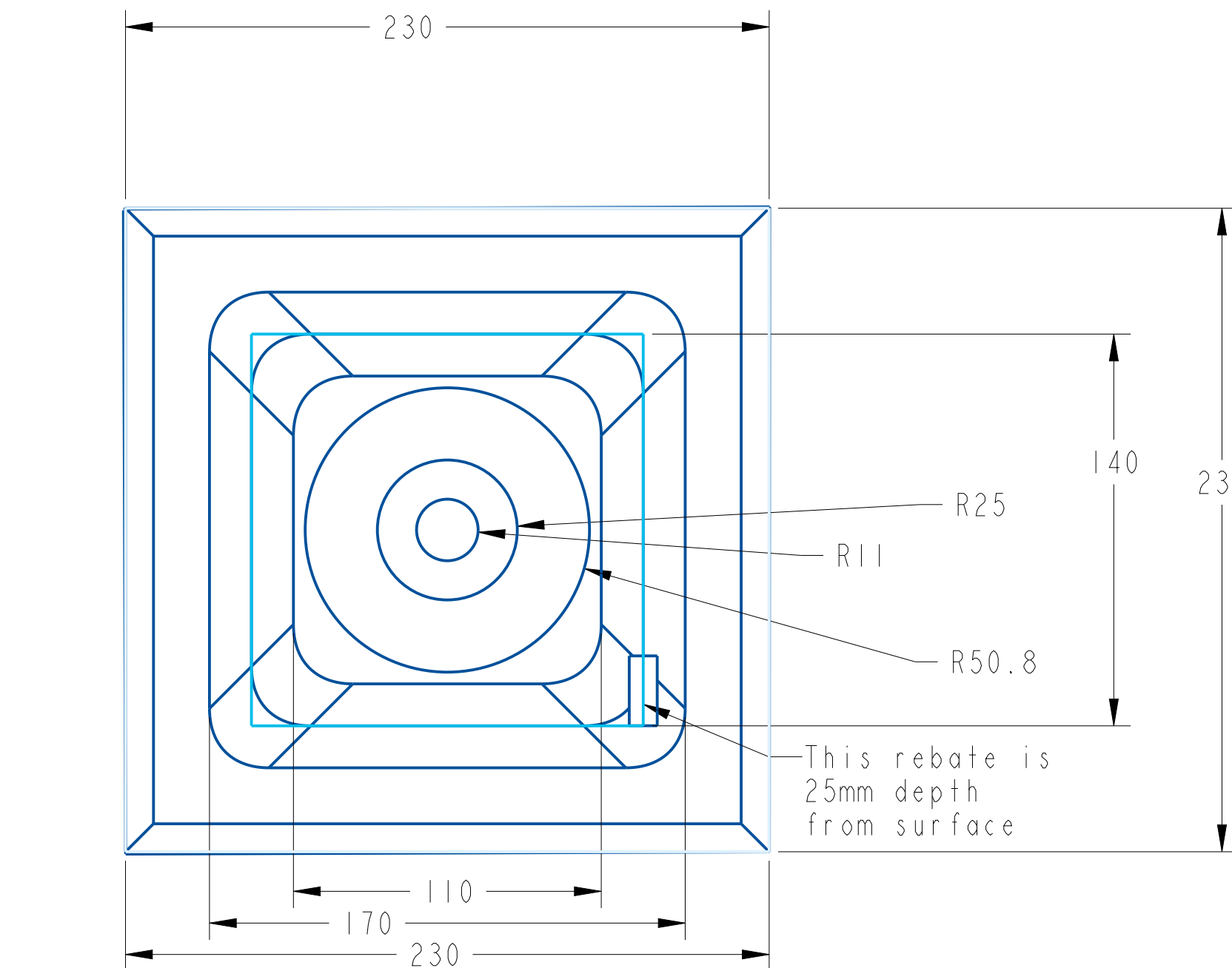

Inner diameter 10.0mm at 60mm deep
Above are 25mm deep rebates

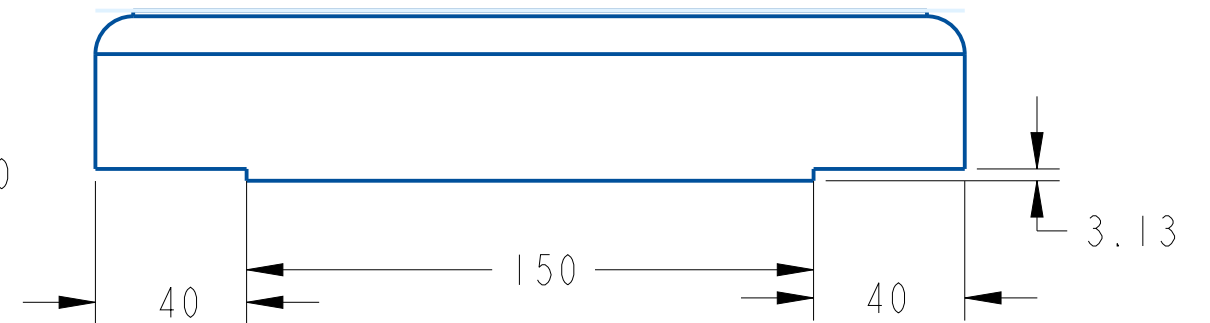

3.125mm saw blade kerf cut
40mm deep to locate underside cleats



SCALE 1:2

BASE level

Timber section 45mm thick
may be planed on top side for
smoother jointing

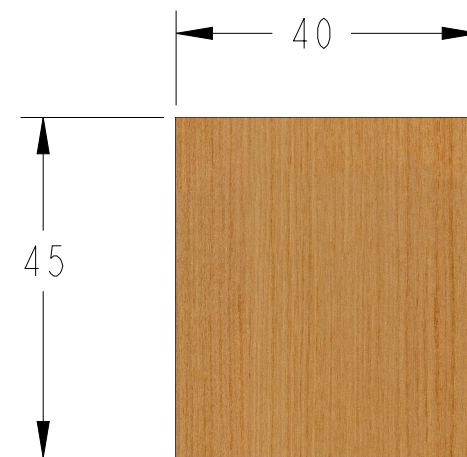
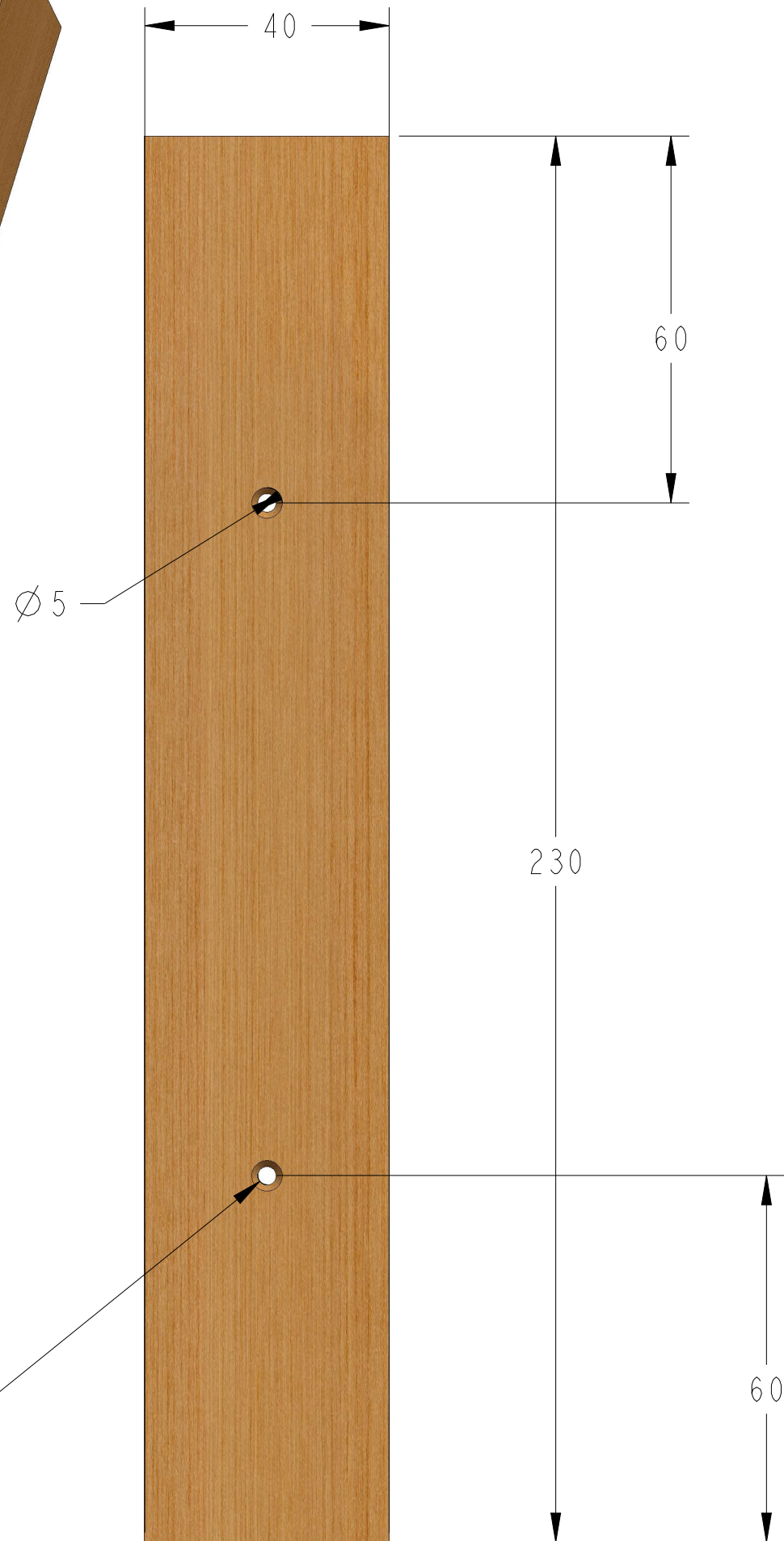

CLEATS 2 OFF

SCALE 1:1

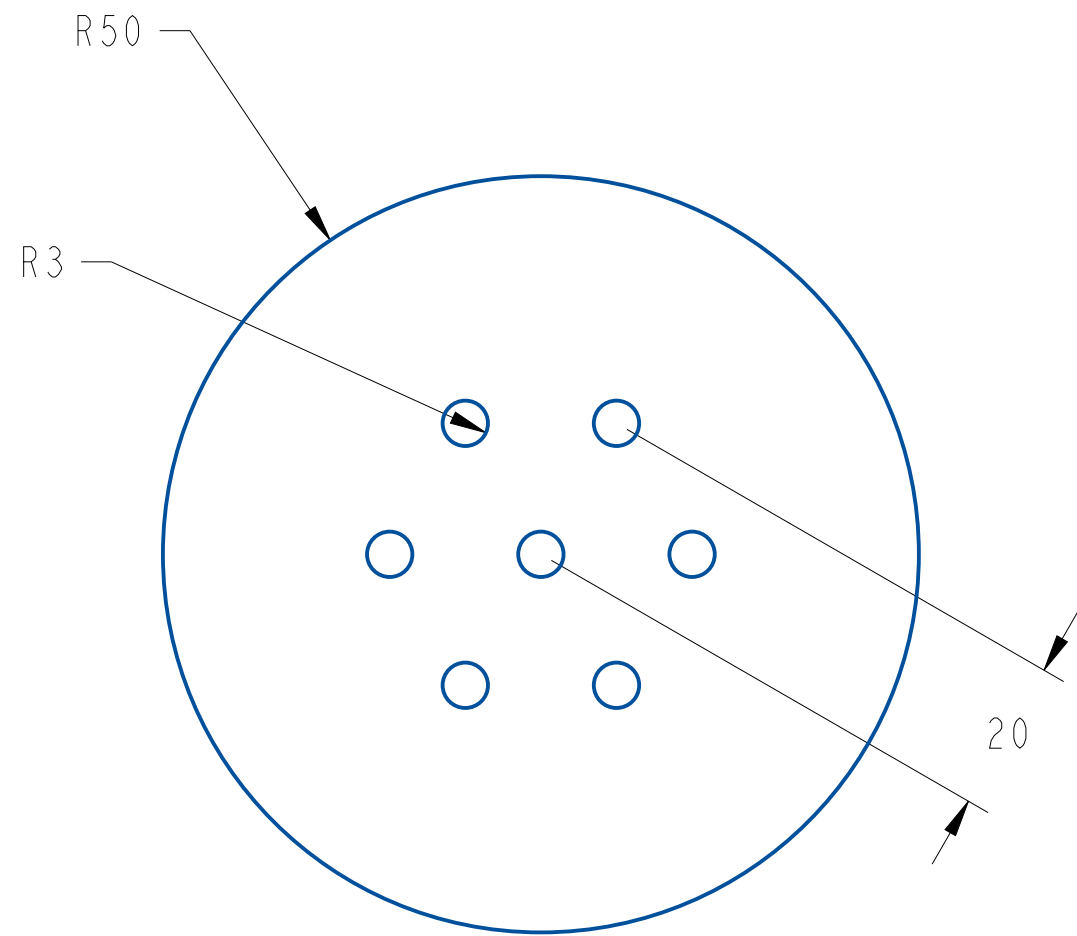

SCALE 1:1

DRAIN SEPARATOR
ON BASE

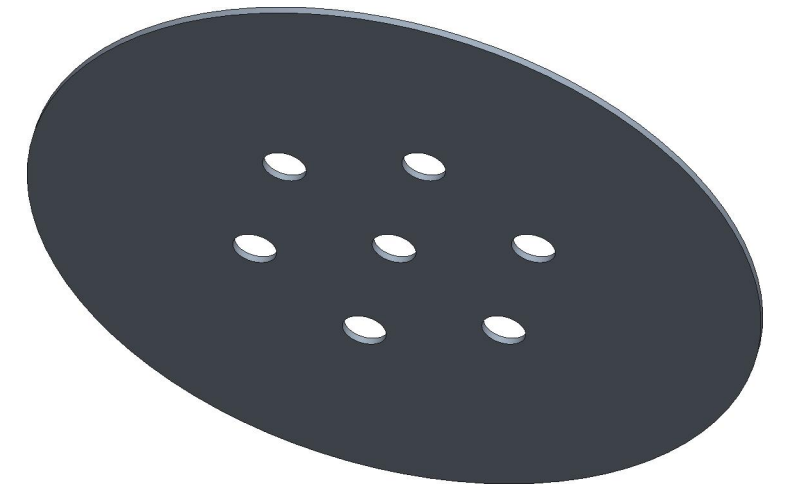

SCALE 1:1

ALL SEPARATORS 1MM THICK
ELSE ADJUST DEPTH OF REBATE TO MAINTAIN
A MINIMUM OF 5MM CLEARANCE BETWEEN FACES
OF SEPARATORS WHEN STACKED

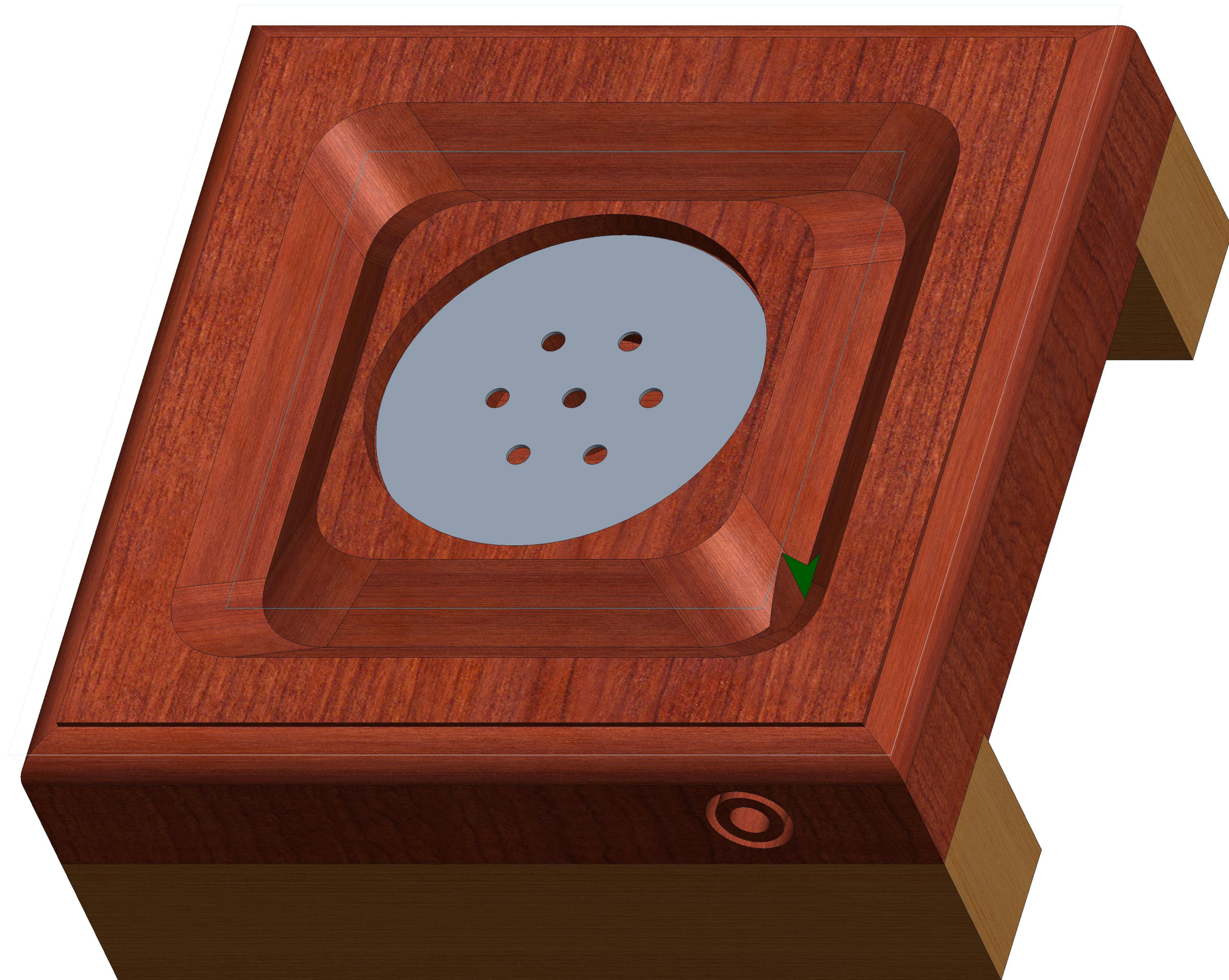

BASE ASSEMBLY

CLEATs are set across the grain
of base to reduce effects of "cupping"
of the base material



SCALE 1:1

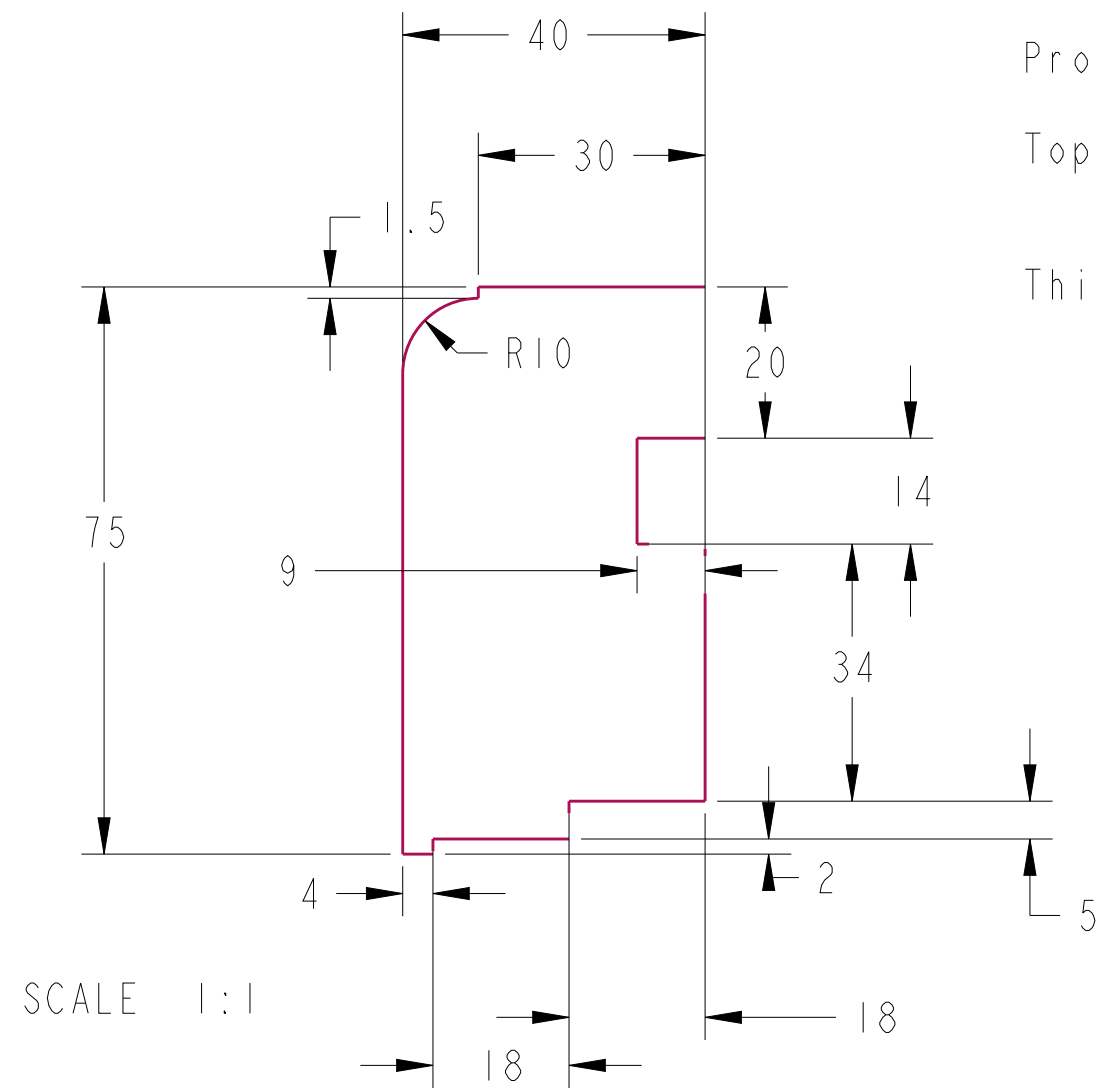

Profile of side

Top lip now 1.5mm

This extrusion is for a 230mm overall length box

FOUR OFF

TWO STANDARD SIDES
1 AS ADJ TO ENTRANCE SIDE
1 AS ENTRANCE SIDE

SIDE

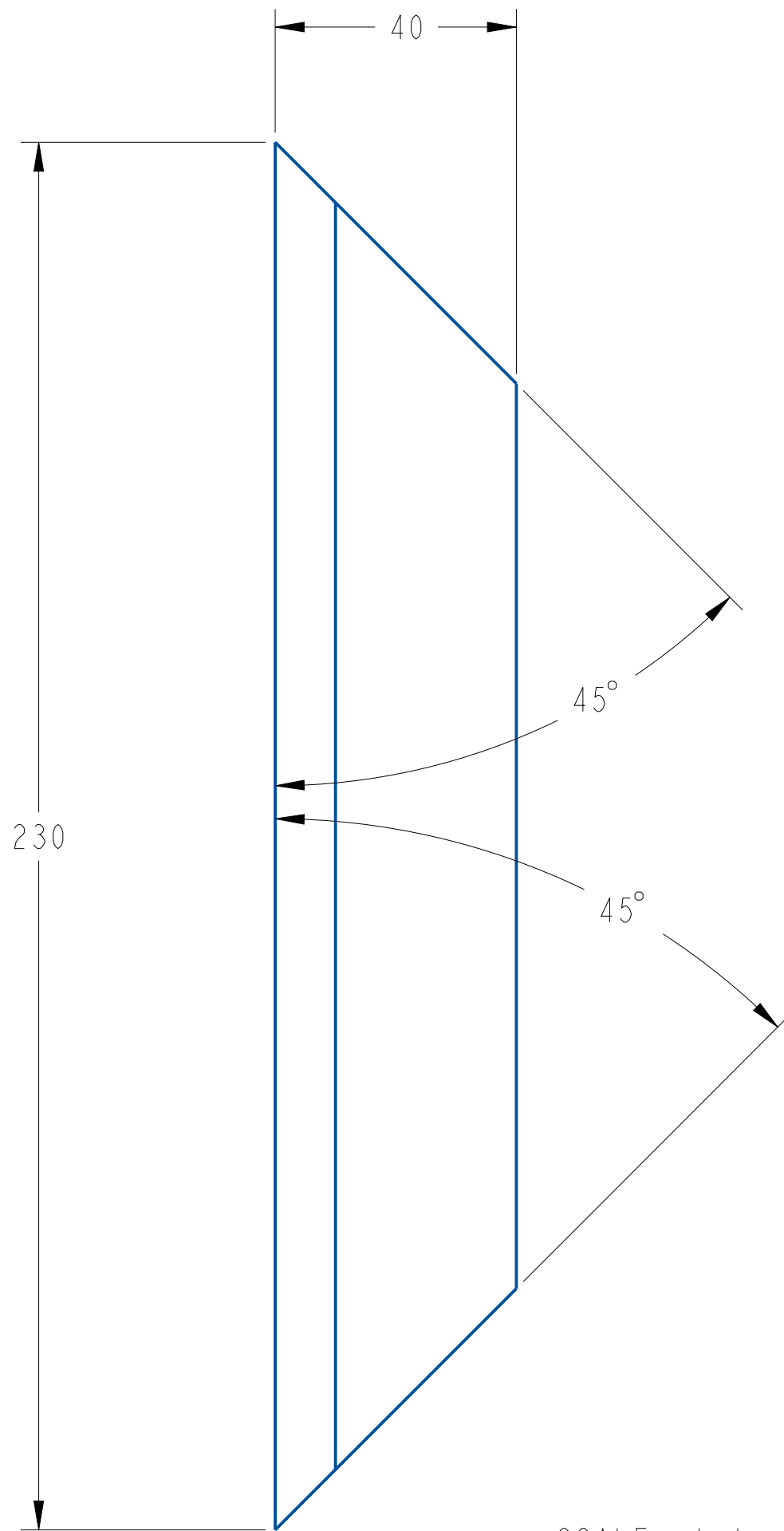

SCALE 1:1

SIDE CUT TO 45 DEGREES



SCALE 1:1

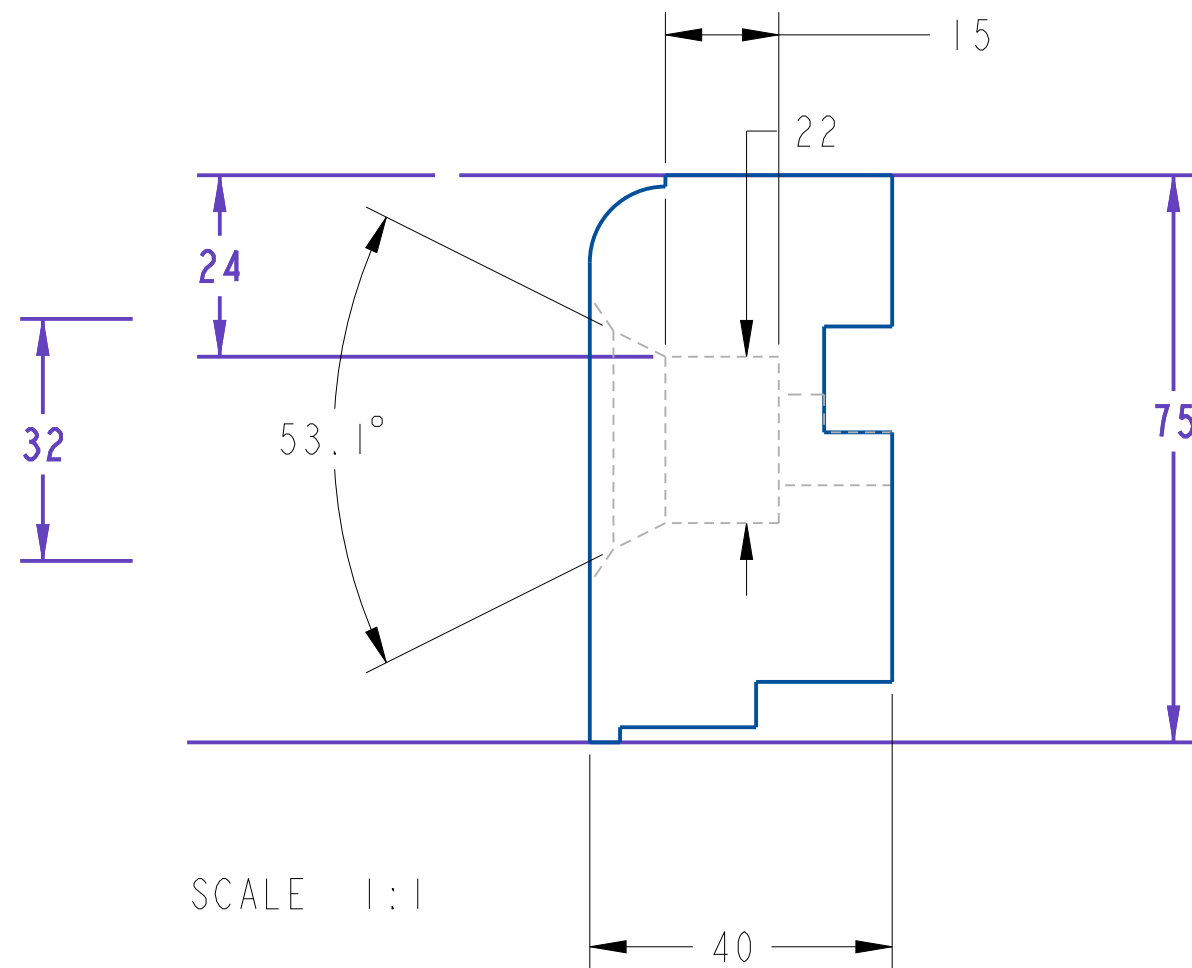

SCALE 1:1

SIDE ENTRANCE



SCALE 1:2

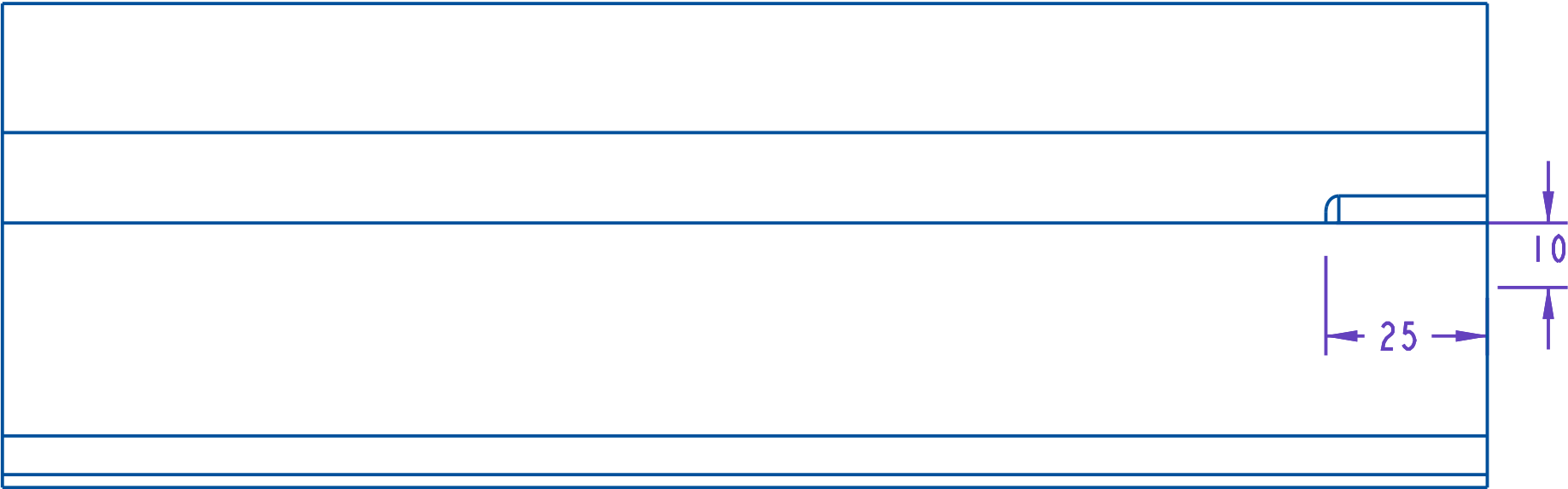

SCALE 1:1

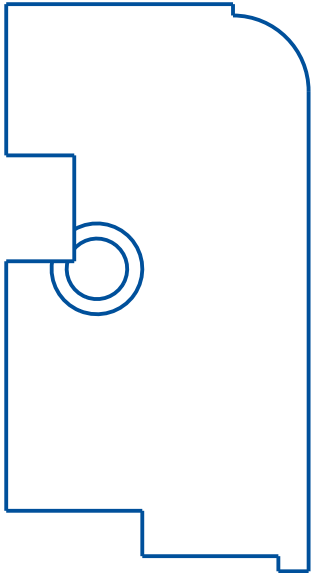

SIDE ADJACENT TO ENTRANCE

Shows the depth of drill
after assembly



SCALE 1:2



SCALE 1:2

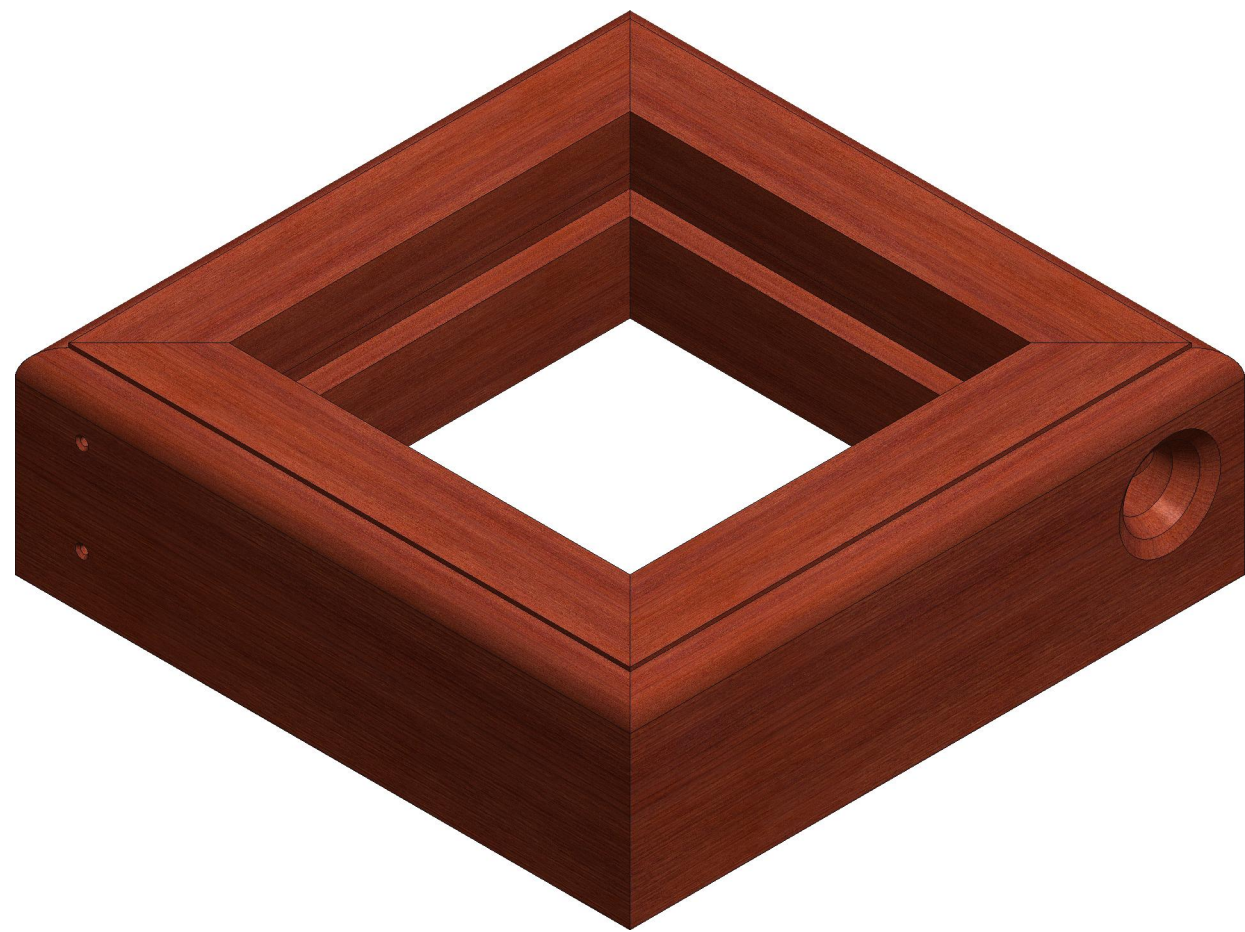

SCALE 1:2



SCALE 1:2

ASSEMBLED SIDES

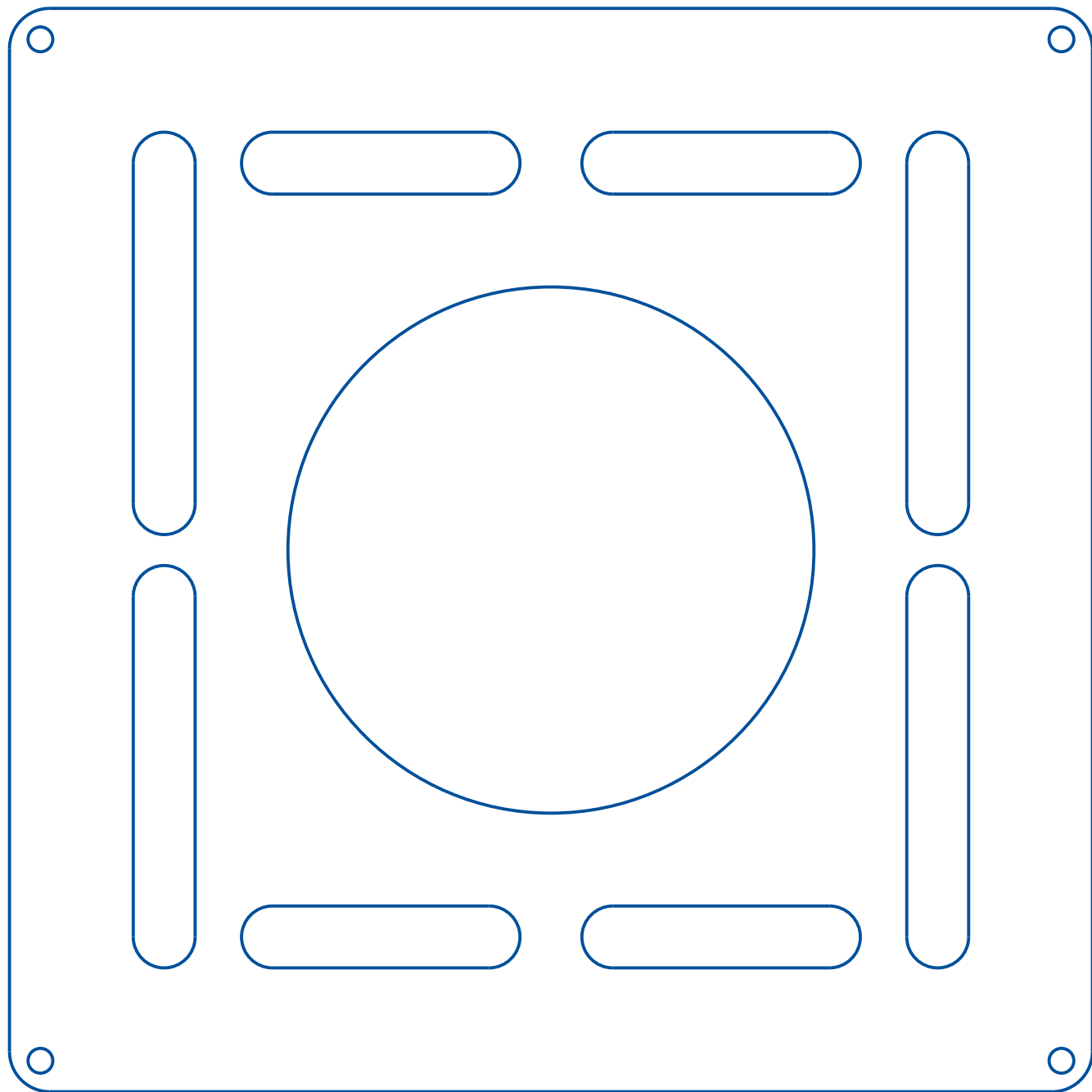

SCALE 1:1

SEPARATOR 175MM

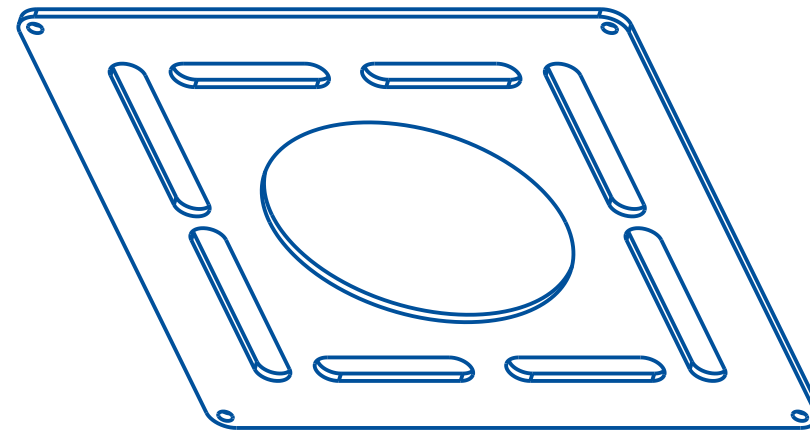

SCALE 1:2

ALL SEPARATORS 1MM THICK
ELSE ADJUST DEPTH OF REBATE TO MAINTAIN
A MINIMUM OF 5MM CLEARANCE BETWEEN FACES

TH & TC 175mm separator in top level

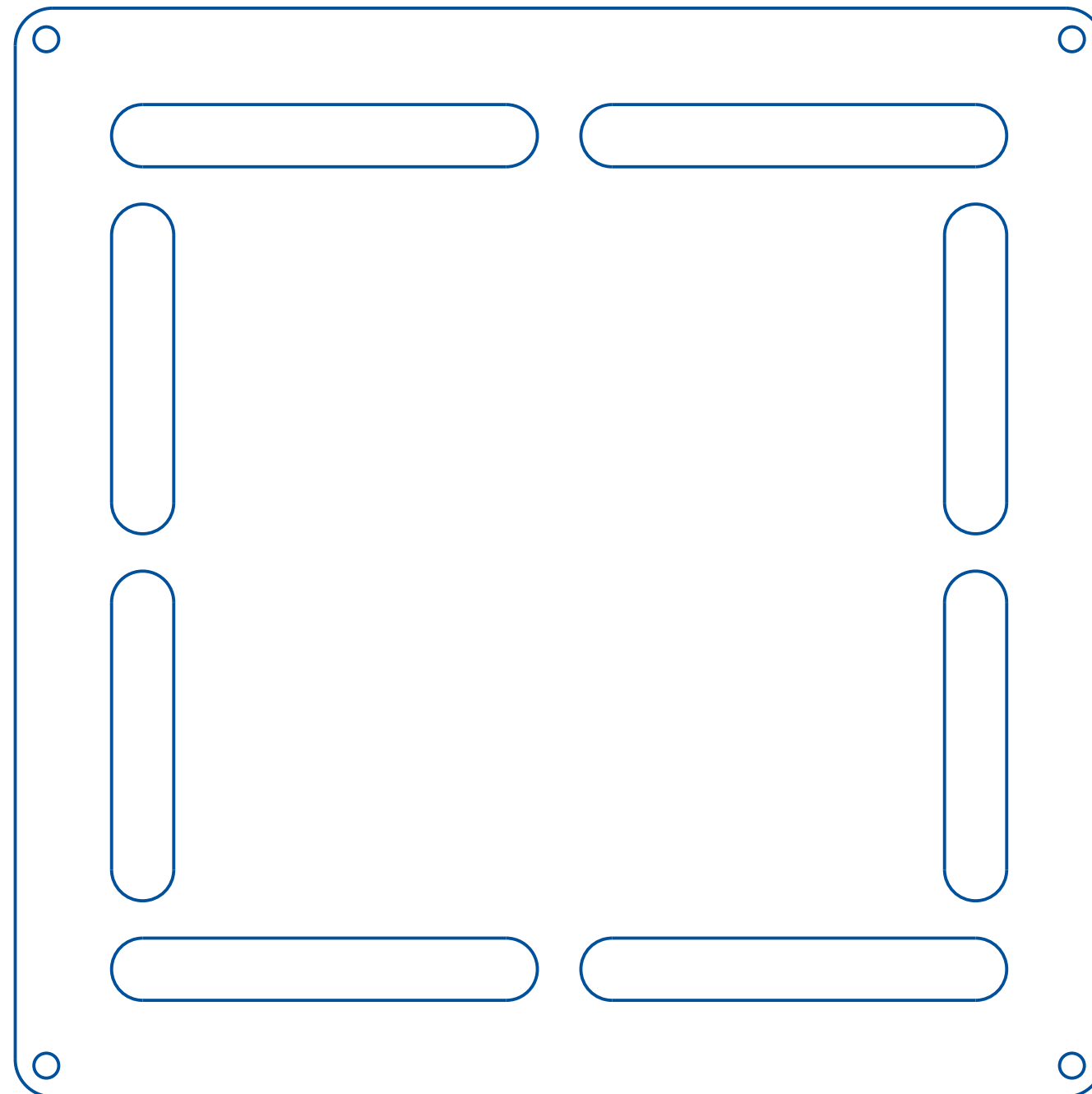

SCALE 1:1

SEPARATOR 175MM

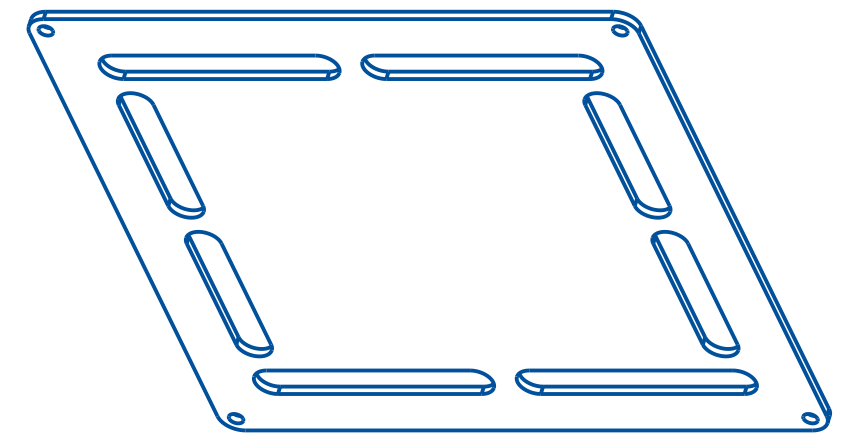

ALL SEPARATORS 1MM THICK

ELSE ADJUST DEPTH OF REBATE TO MAINTAIN
A MINIMUM OF 5MM CLEARANCE BETWEEN FACES

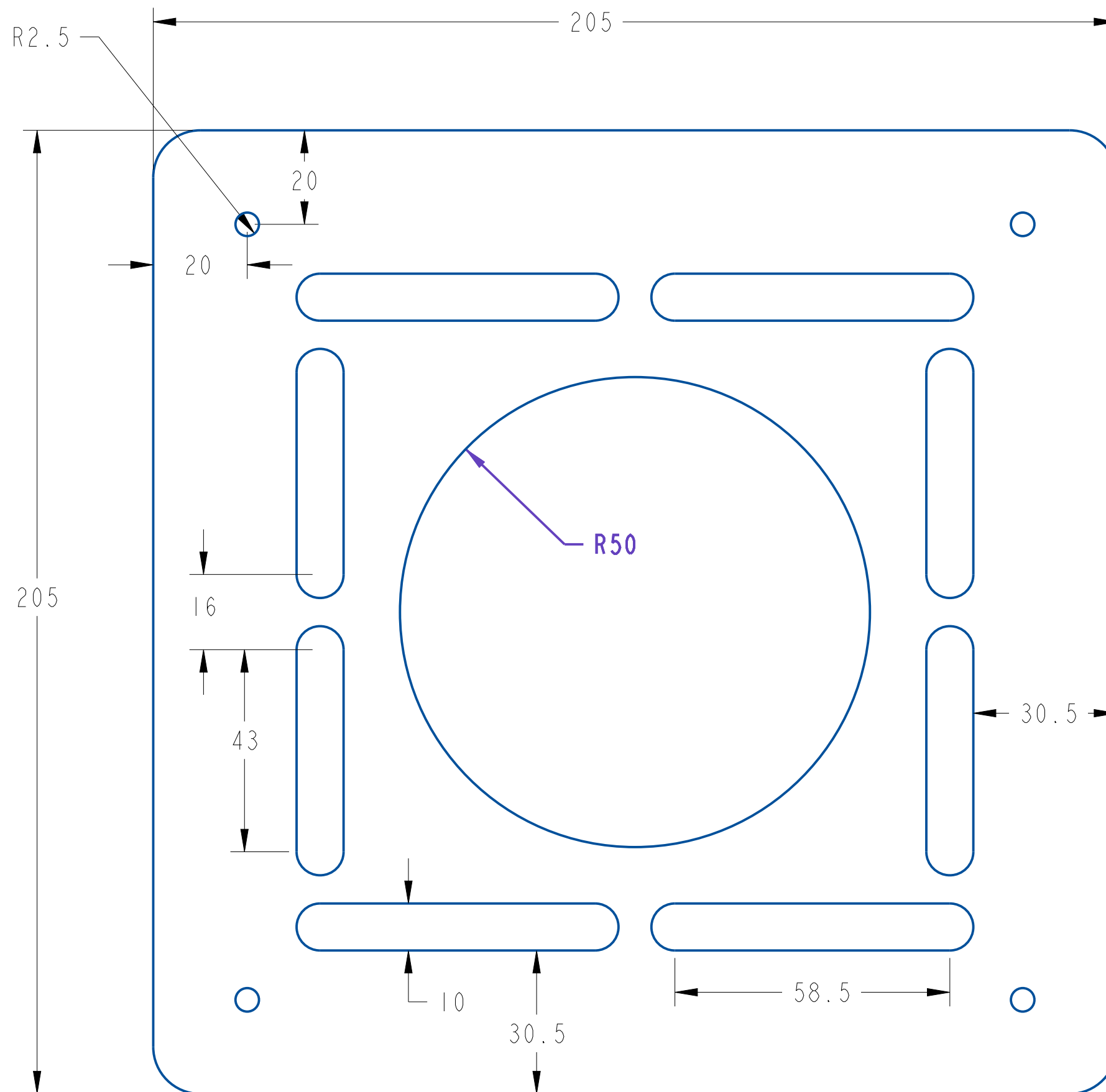

SCALE 1:1

SEPARATOR 205MM

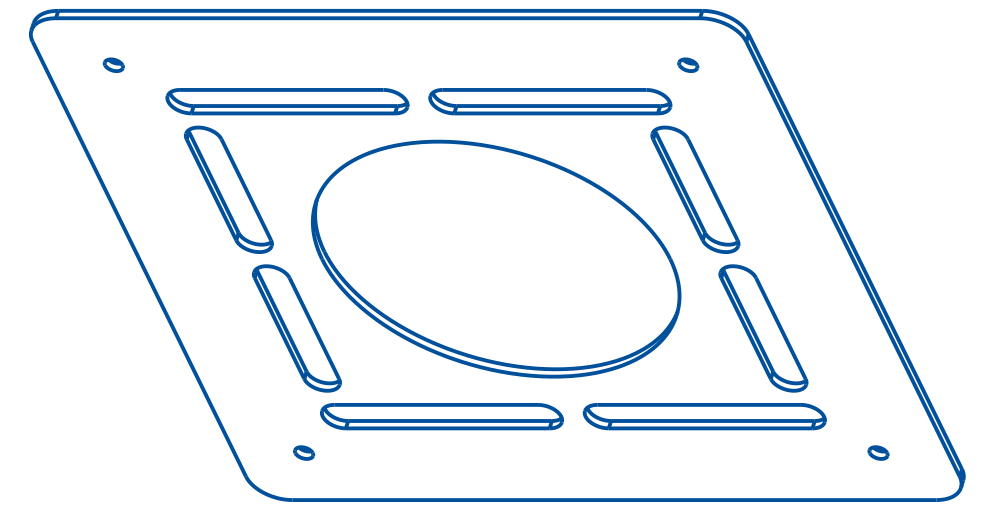

SCALE 1:2

ALL SEPARATORS 1MM THICK

ELSE ADJUST DEPTH OF REBATE TO MAINTAIN

A MINIMUM OF 5MM CLEARANCE BETWEEN FACES

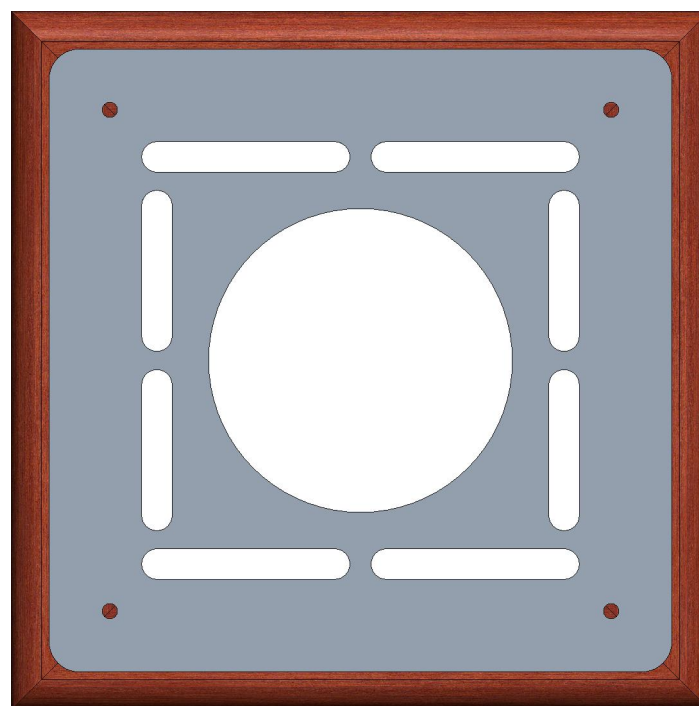
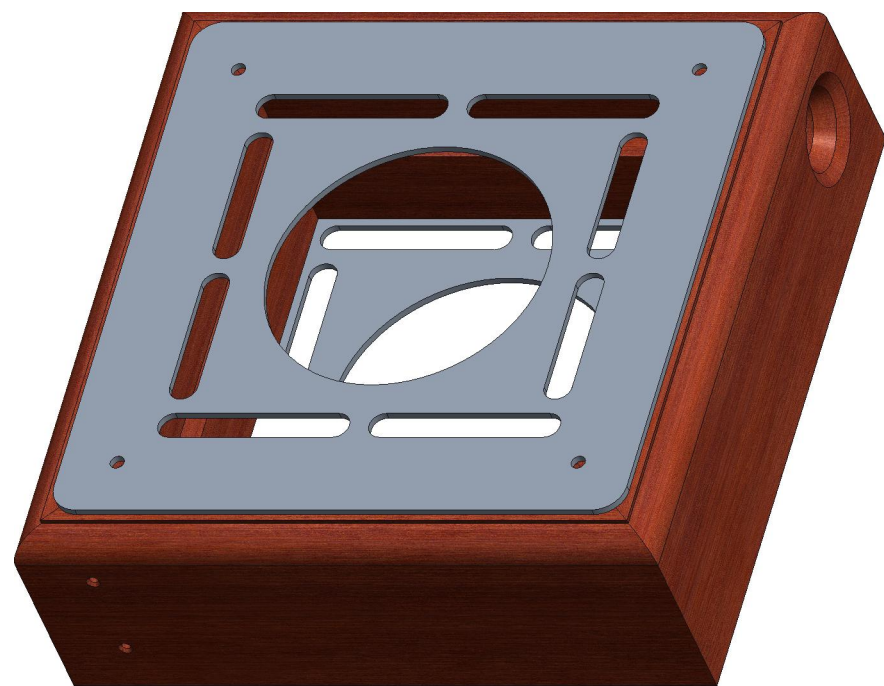

TOP

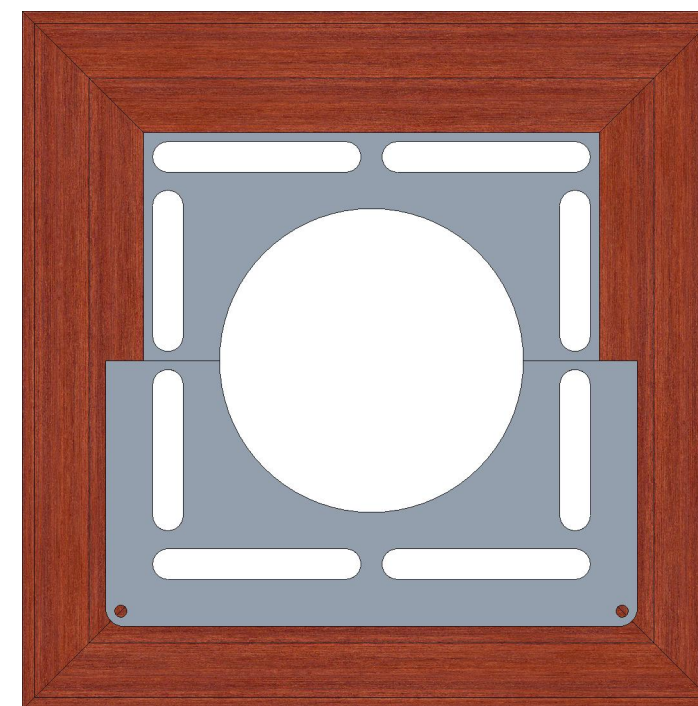

BOTTOM

Note: Only half of base separator shown for clarity

ASSEMBLED BROOD Usually 3 OFF

KEEP UPPER AND LOWER SEPARATOR
SLOTS IN THE SAME ORIENTATION

Screws holding each side

There are 8 by 10Gx65mmSS battenn screws in all for each level

SCALE 77:192

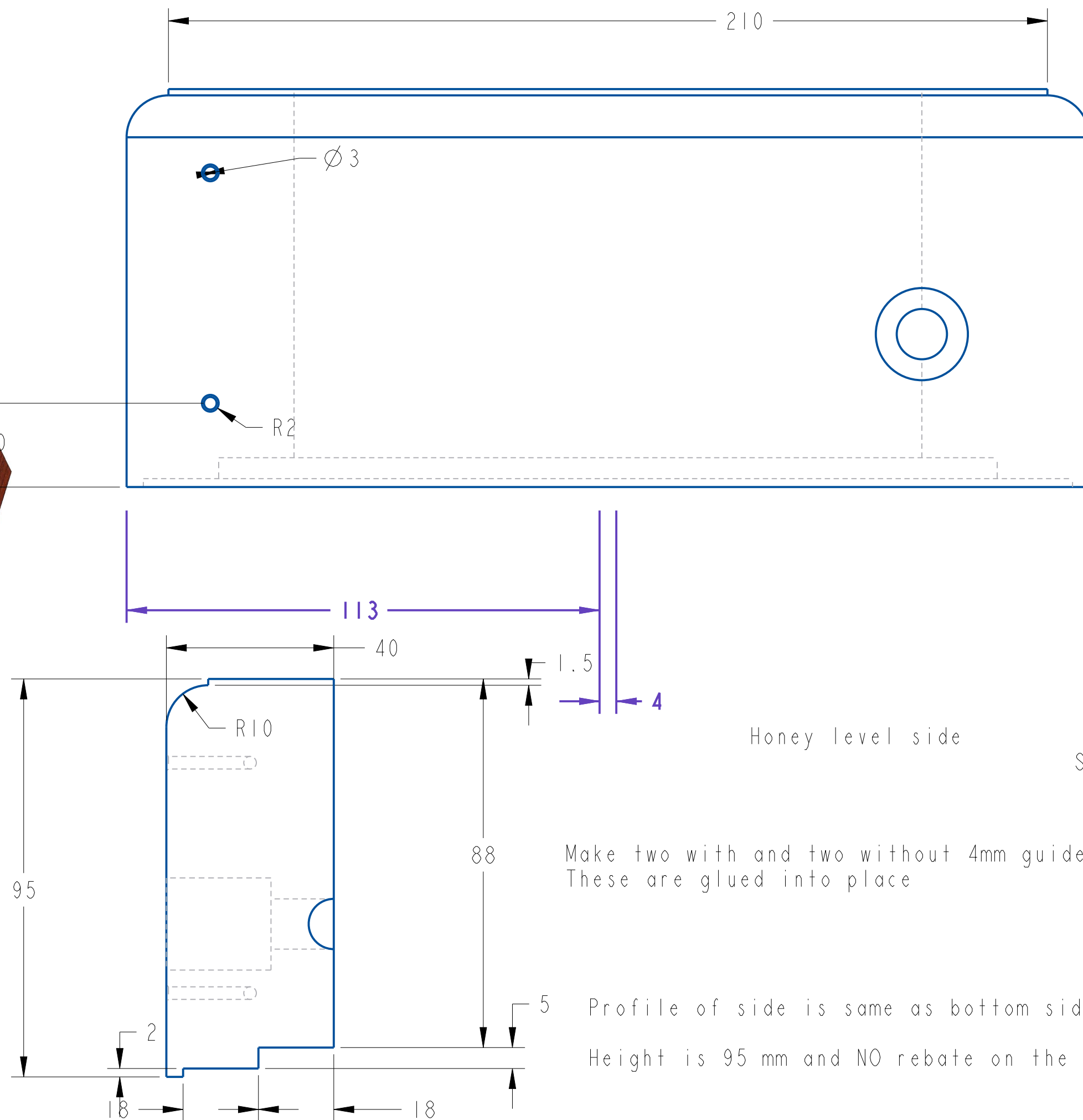



SCALE 1:1

Honey level side NO rebate 2 OFF

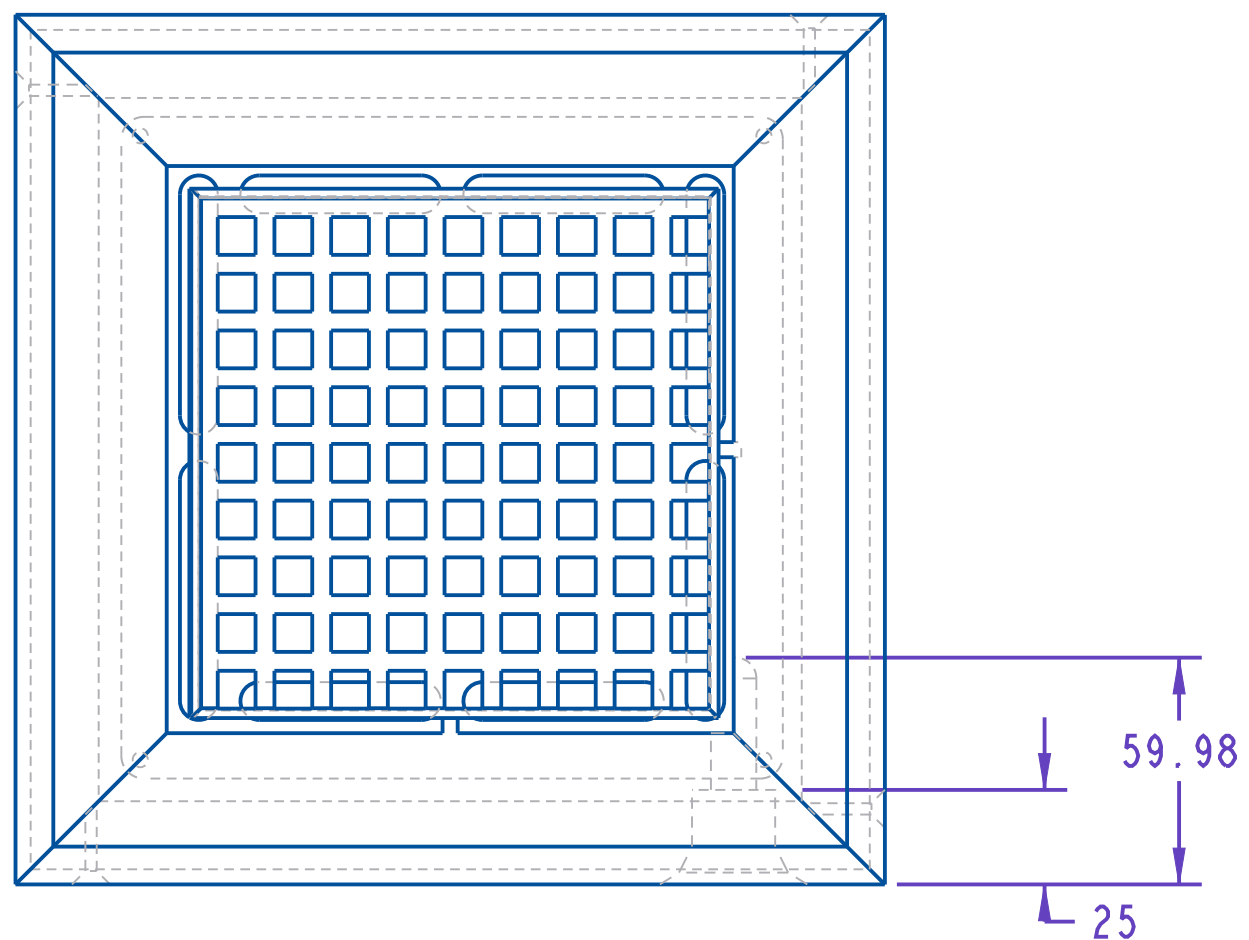
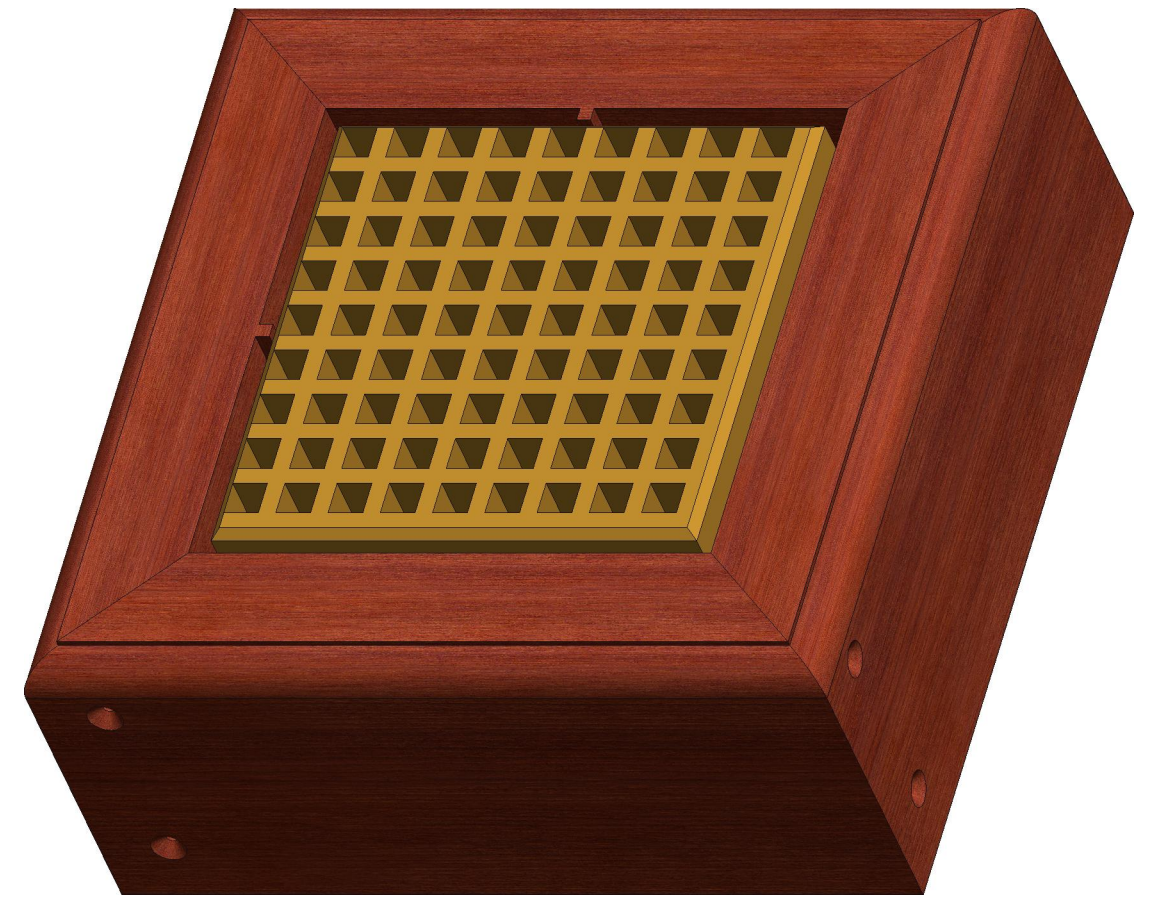
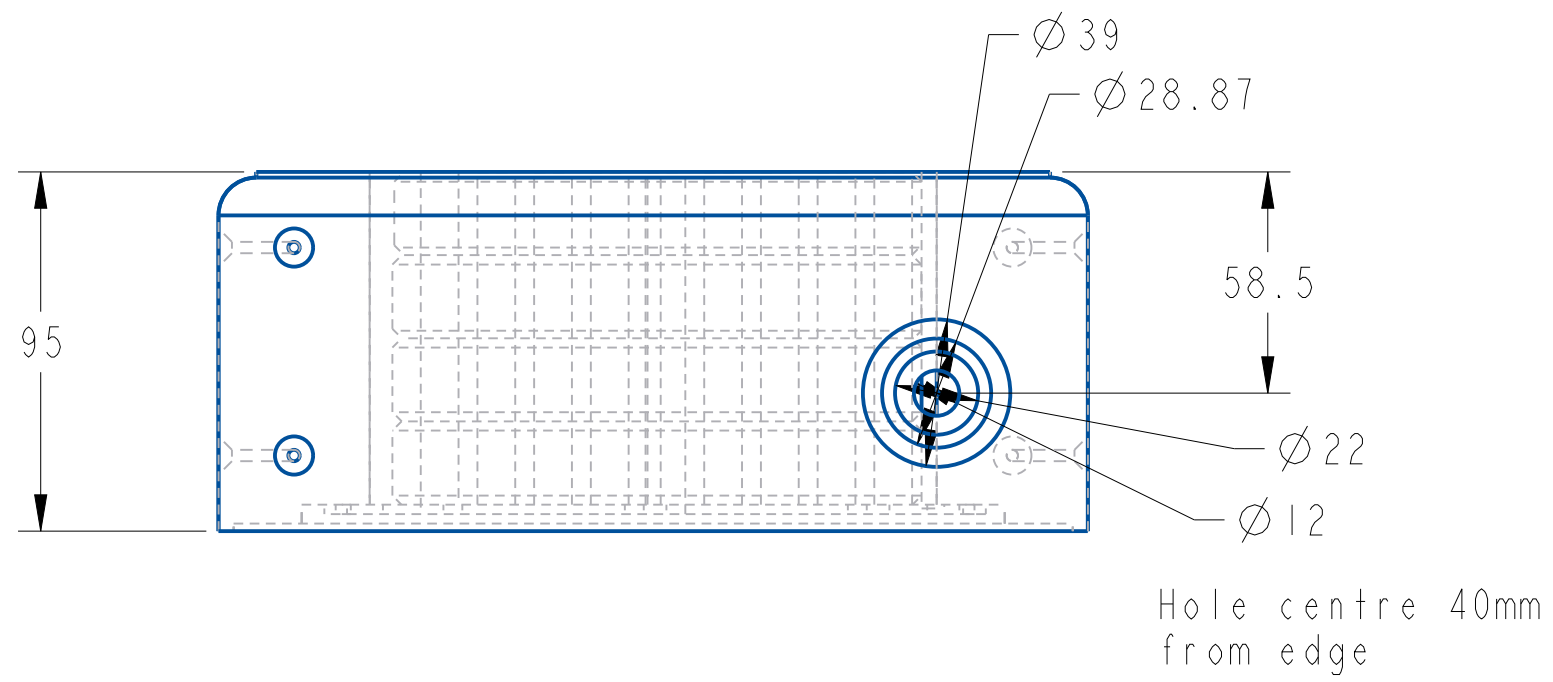

Top Entrance dimensions

SCALE 1:2

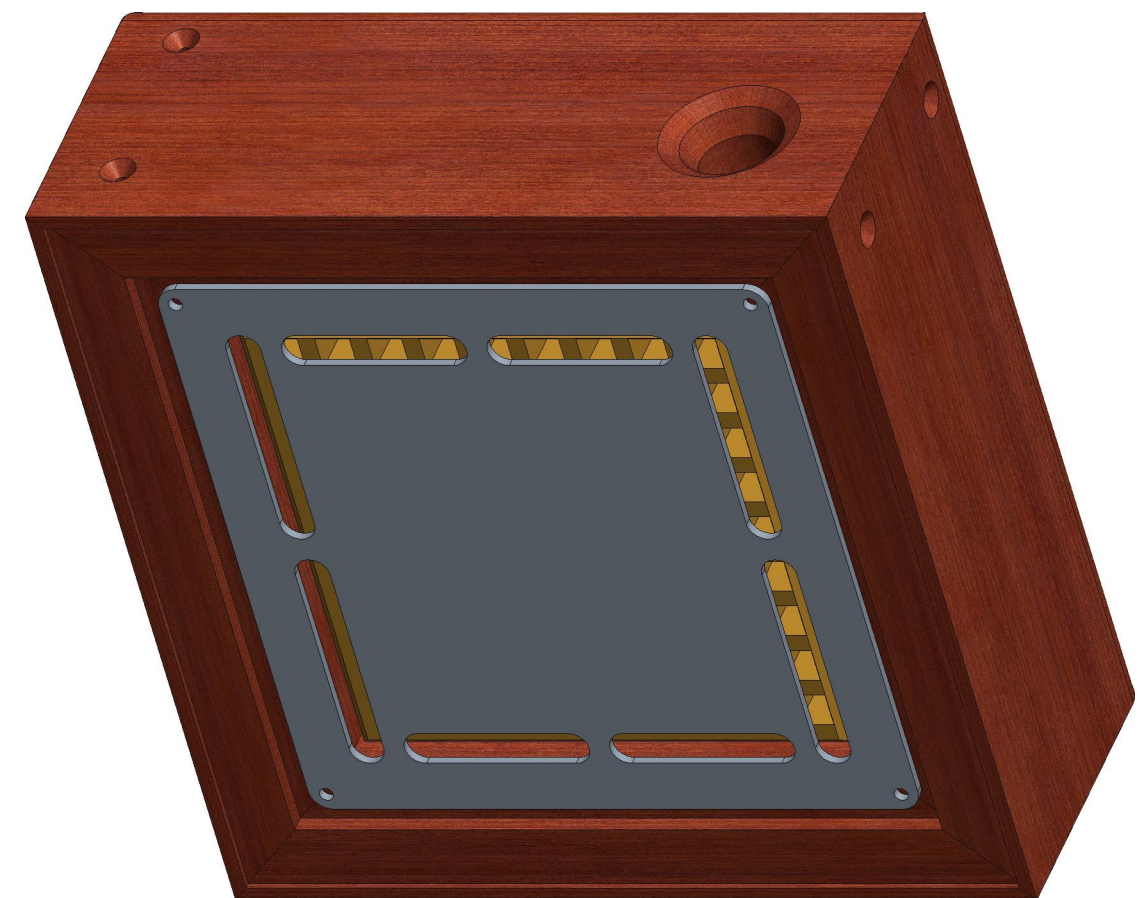

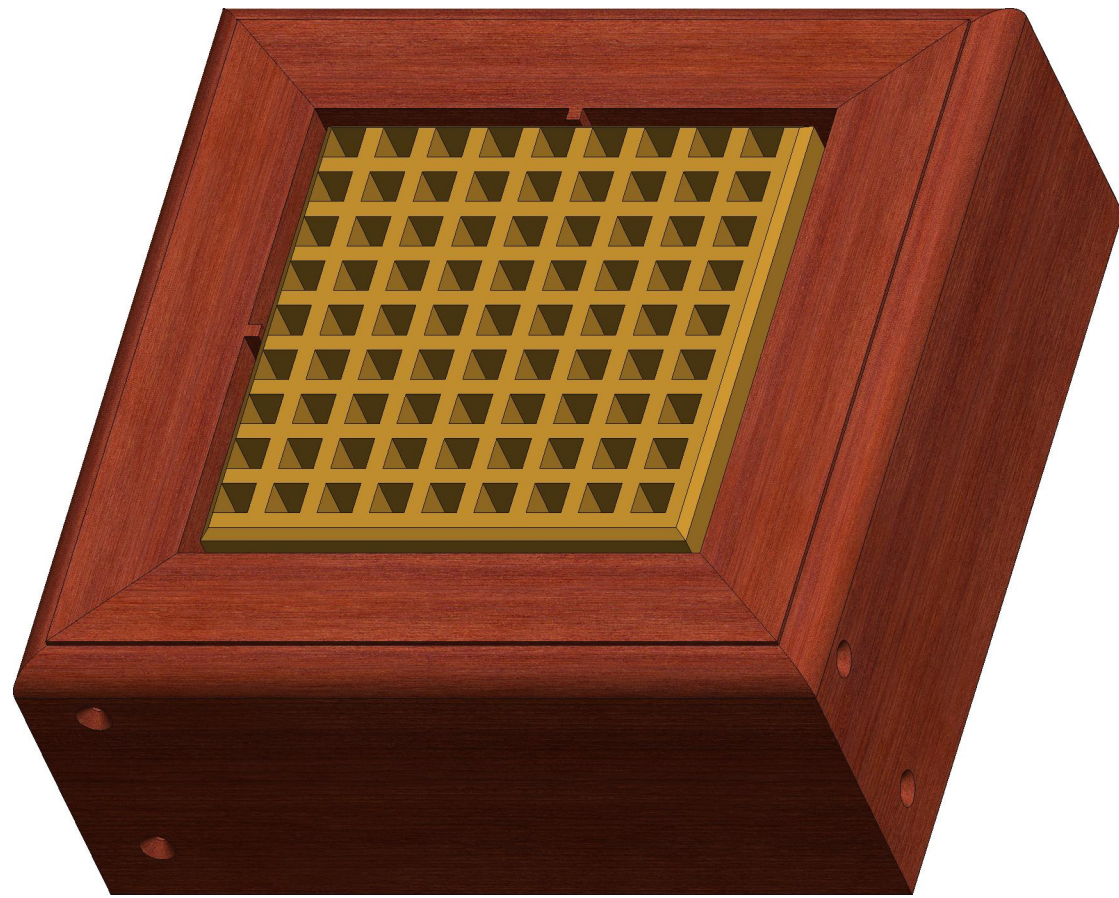

SCALE 1:2

Inspection panel:
clear 1mm PET, taped
in place over Honey tray

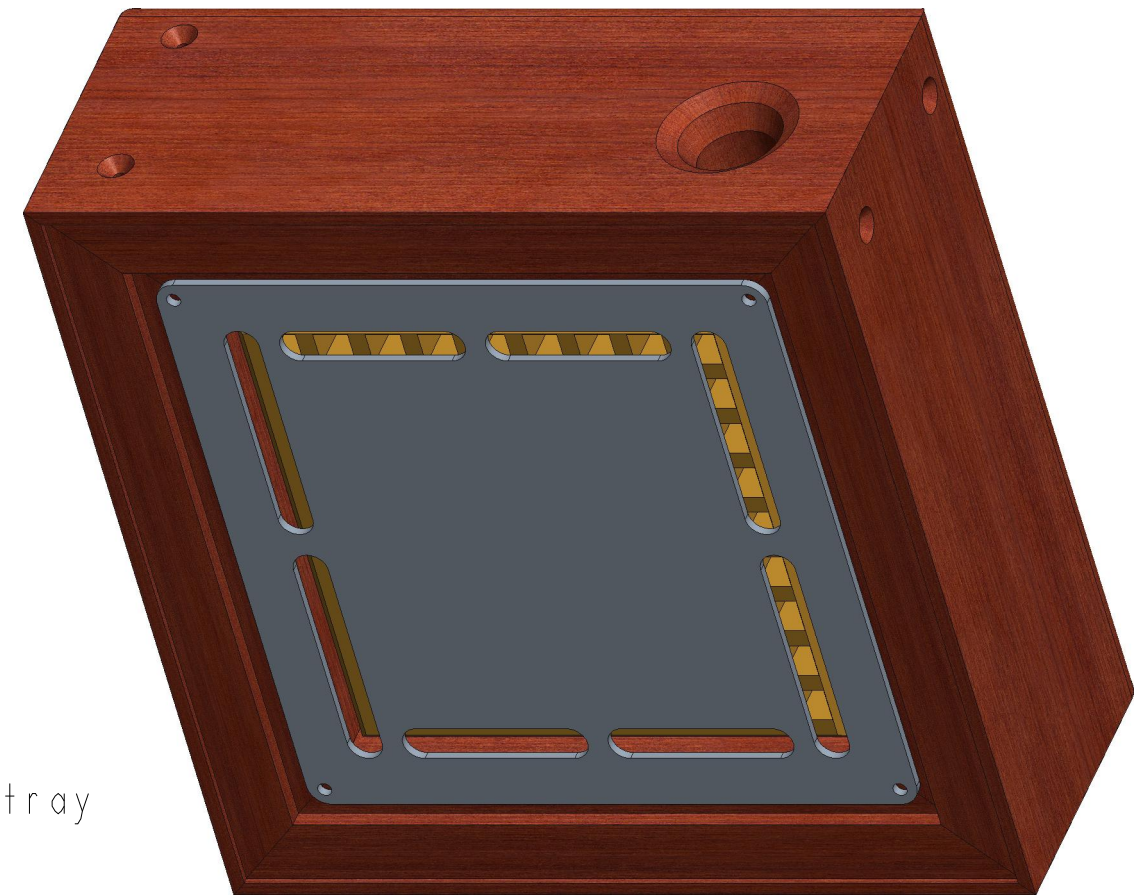

SCALE 1:2



SCALE 1:2

KEEP UPPER AND LOWER SEPARATOR
SLOTS IN THE SAME ORIENTATION

HONEY Moulding shown
in place.

These are sourced at
<http://bobthebeeman.com.au>

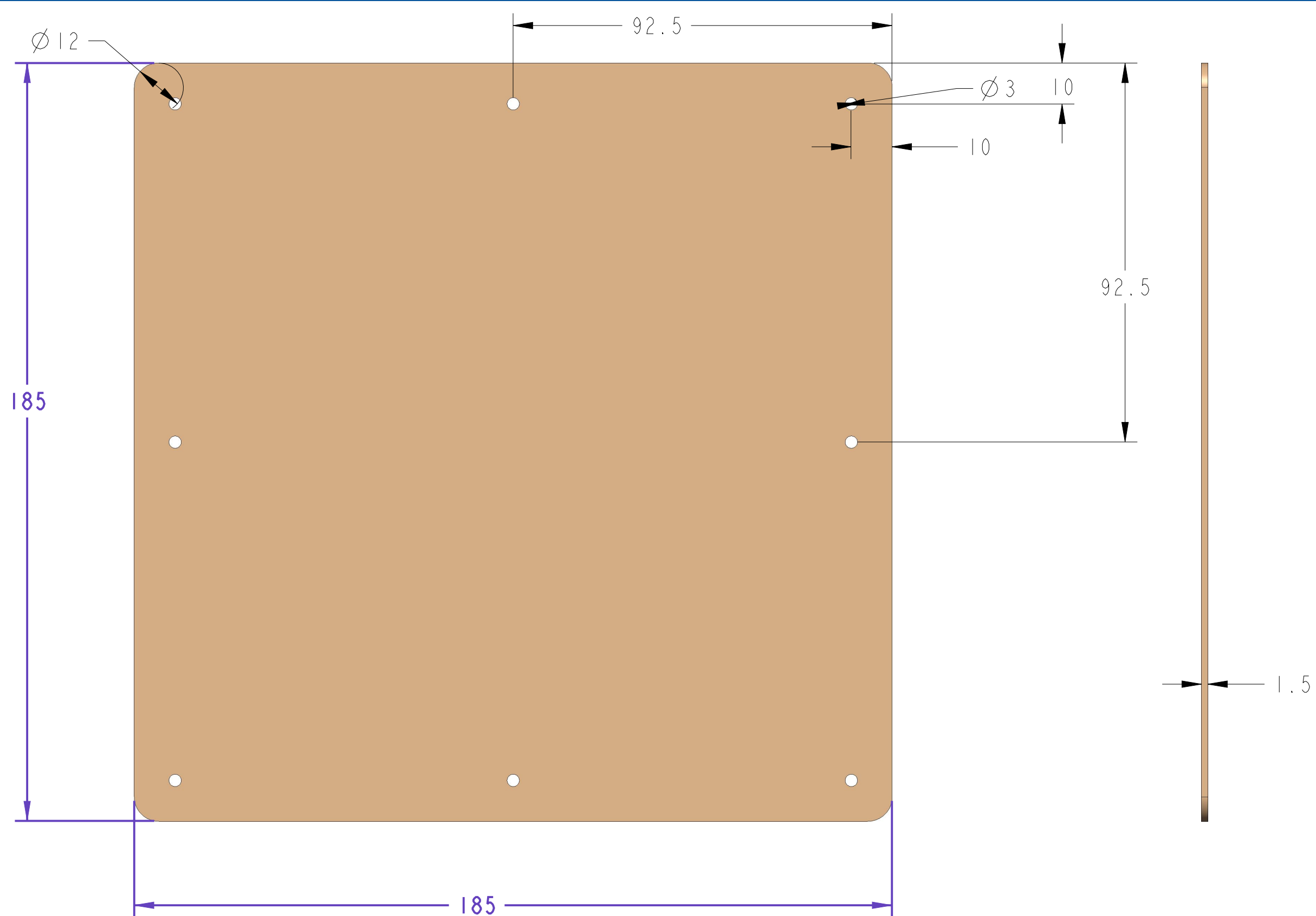

Thermal board 1.5mm ply

SCALE 1:1



SCALE 1:2

Cover / Thermal assembly level detail

Same size as Honey assembly no entrances

This tray is made from the same sized material
as the brood trays , 75mm high

This level contains gravel in the bottom layer with perlite on the top

Thermal 1.5mm ply secured with
8 off 4Gx12 SS pan head

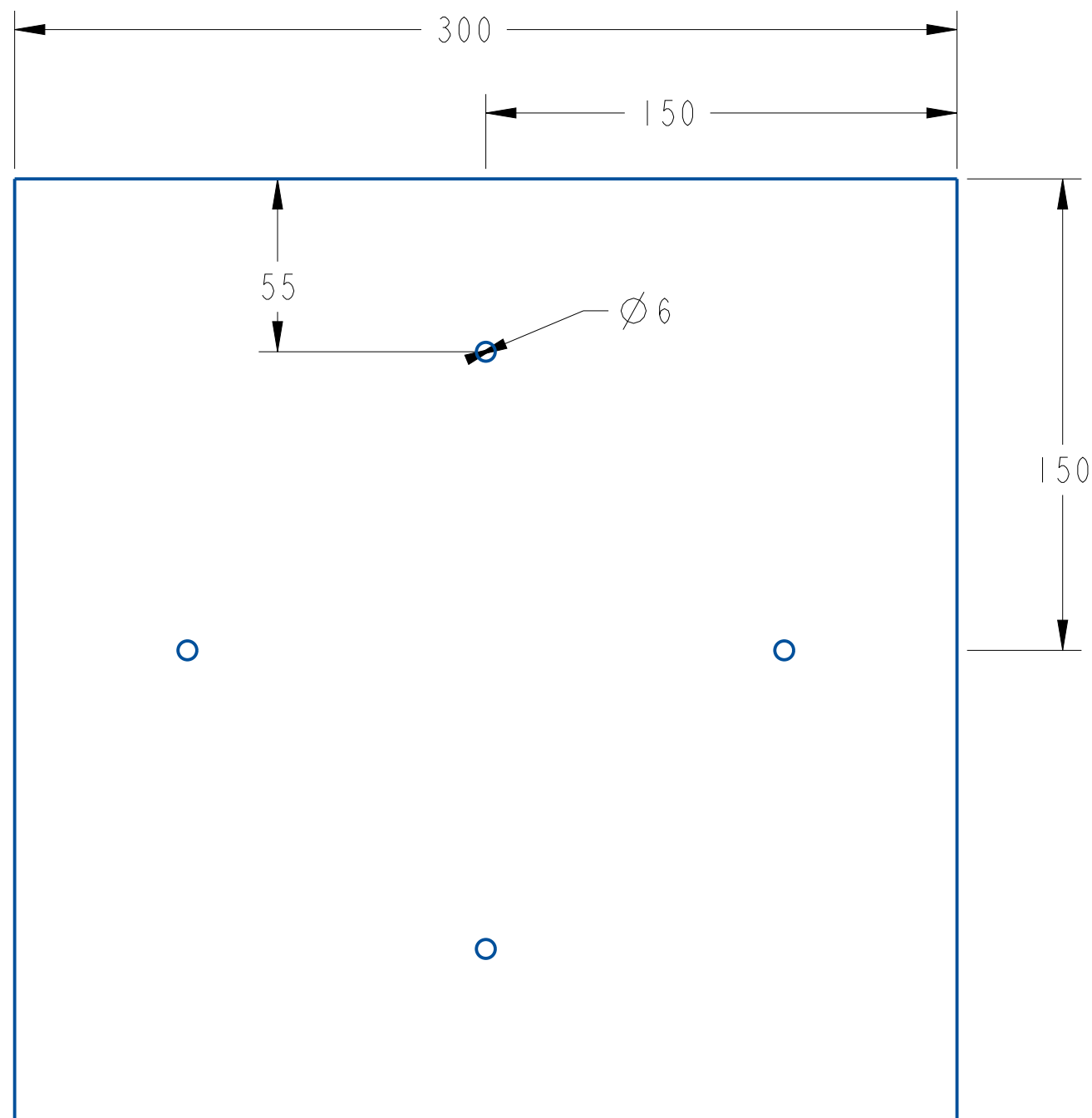

Cover tile

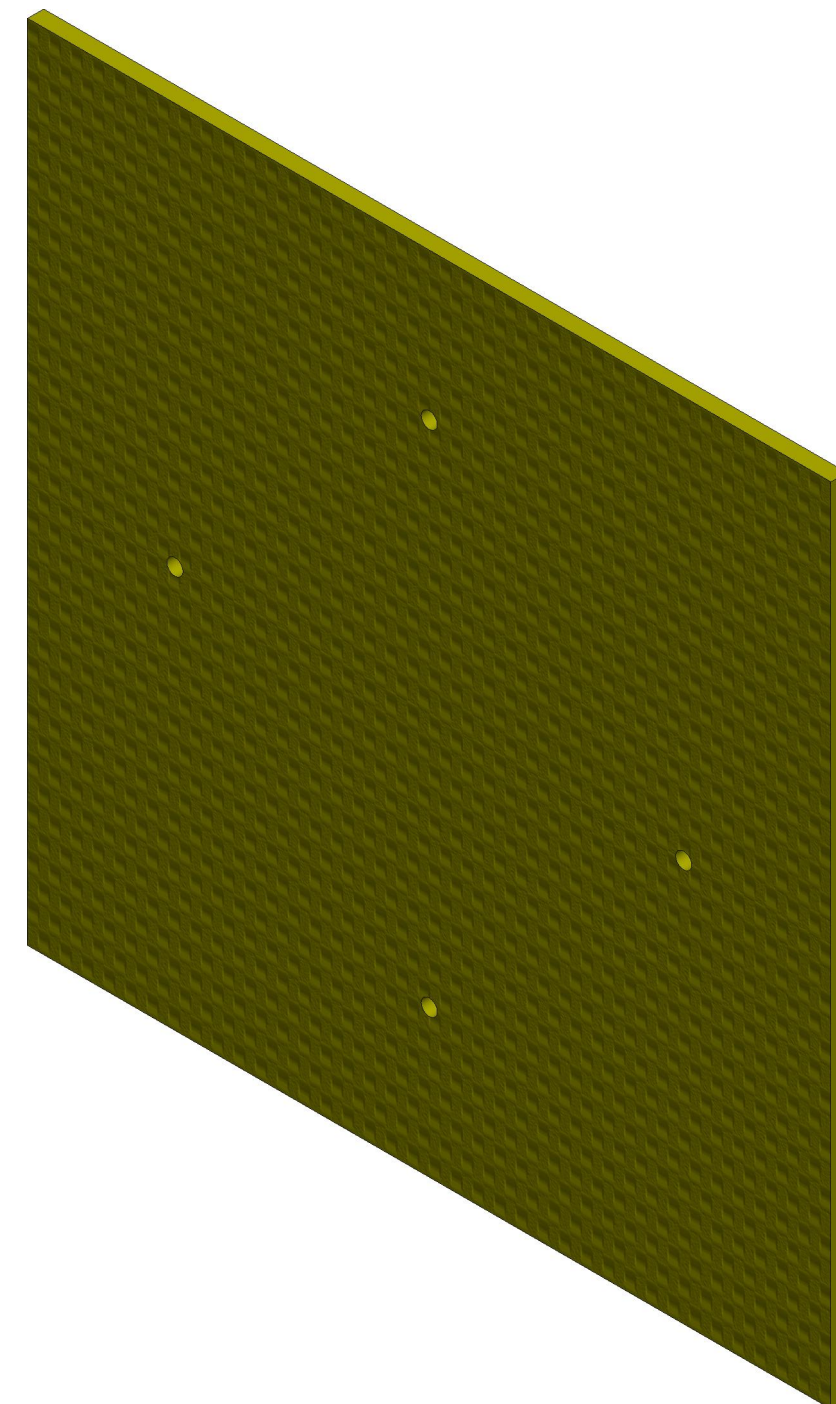

SCALE 1:2

Secured to top of box in one of two ways:

1 With Roof screw 12G x 35mm SS Pan head

2 With a beading of liquid nails, silicone etc

Under the screw use a Dacron weatherproof filling

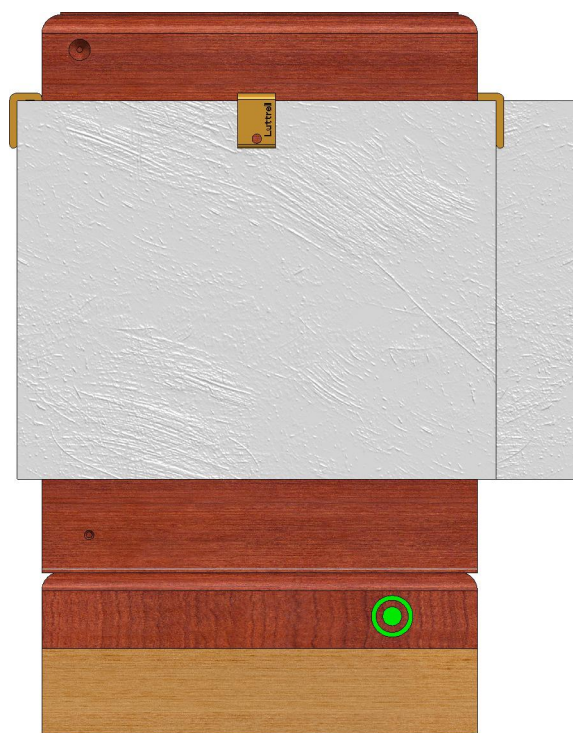
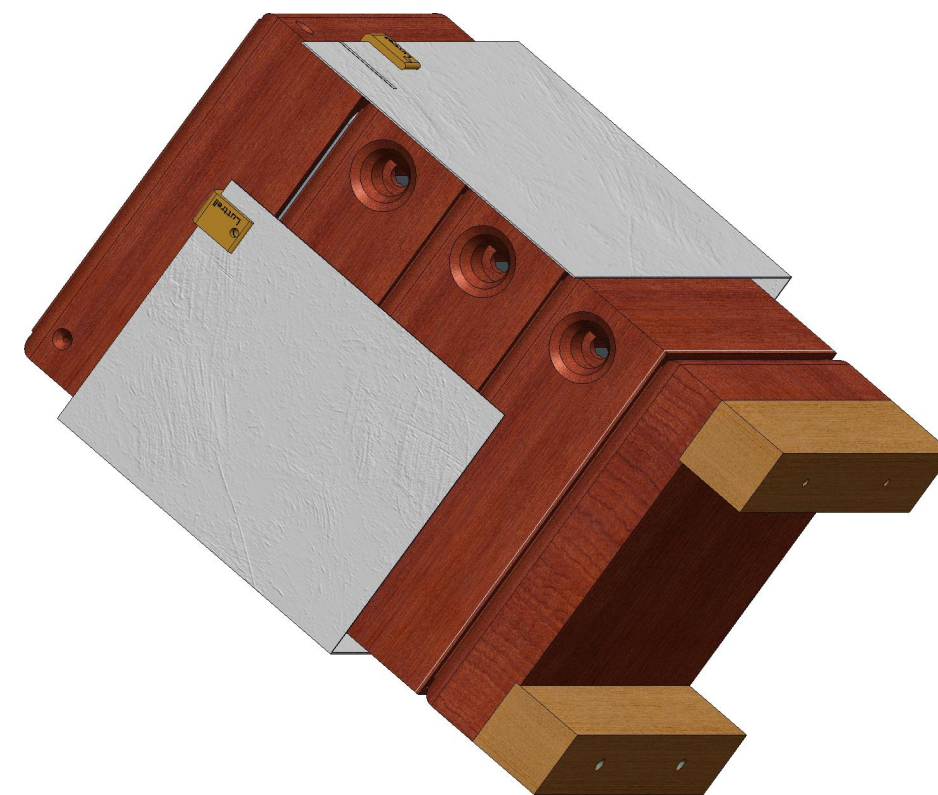
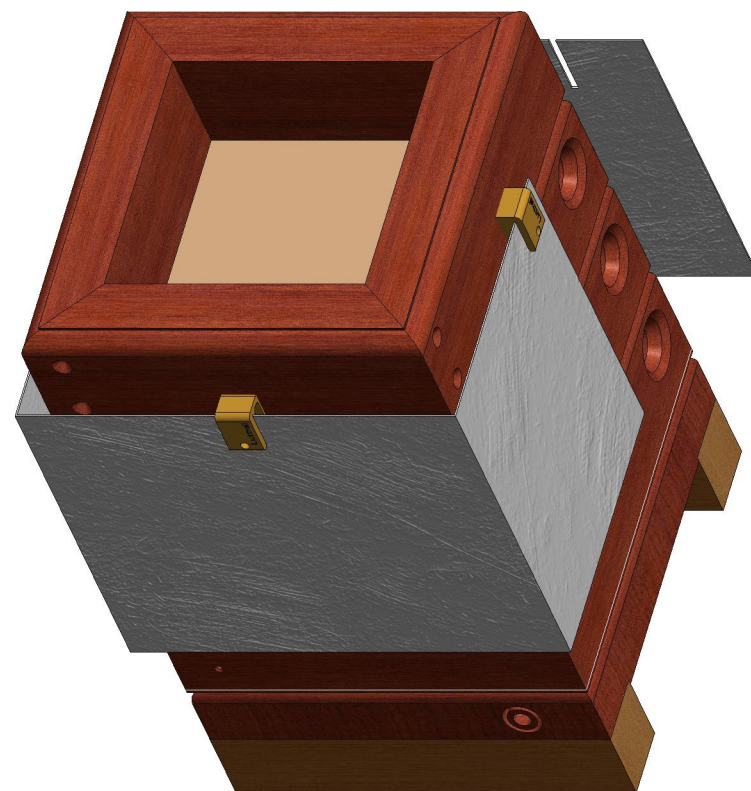
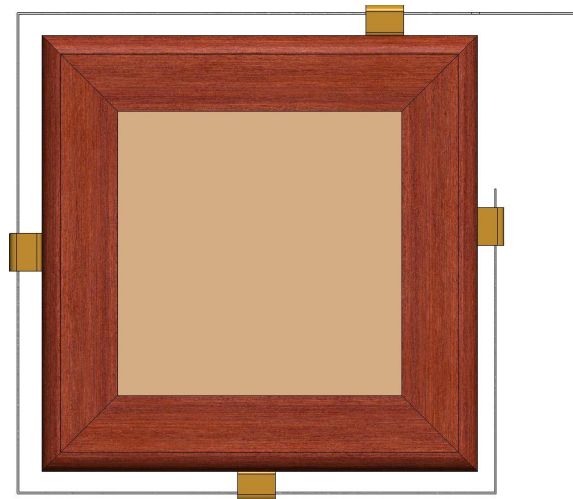

AusINPA Assembly

SCALE 1:4

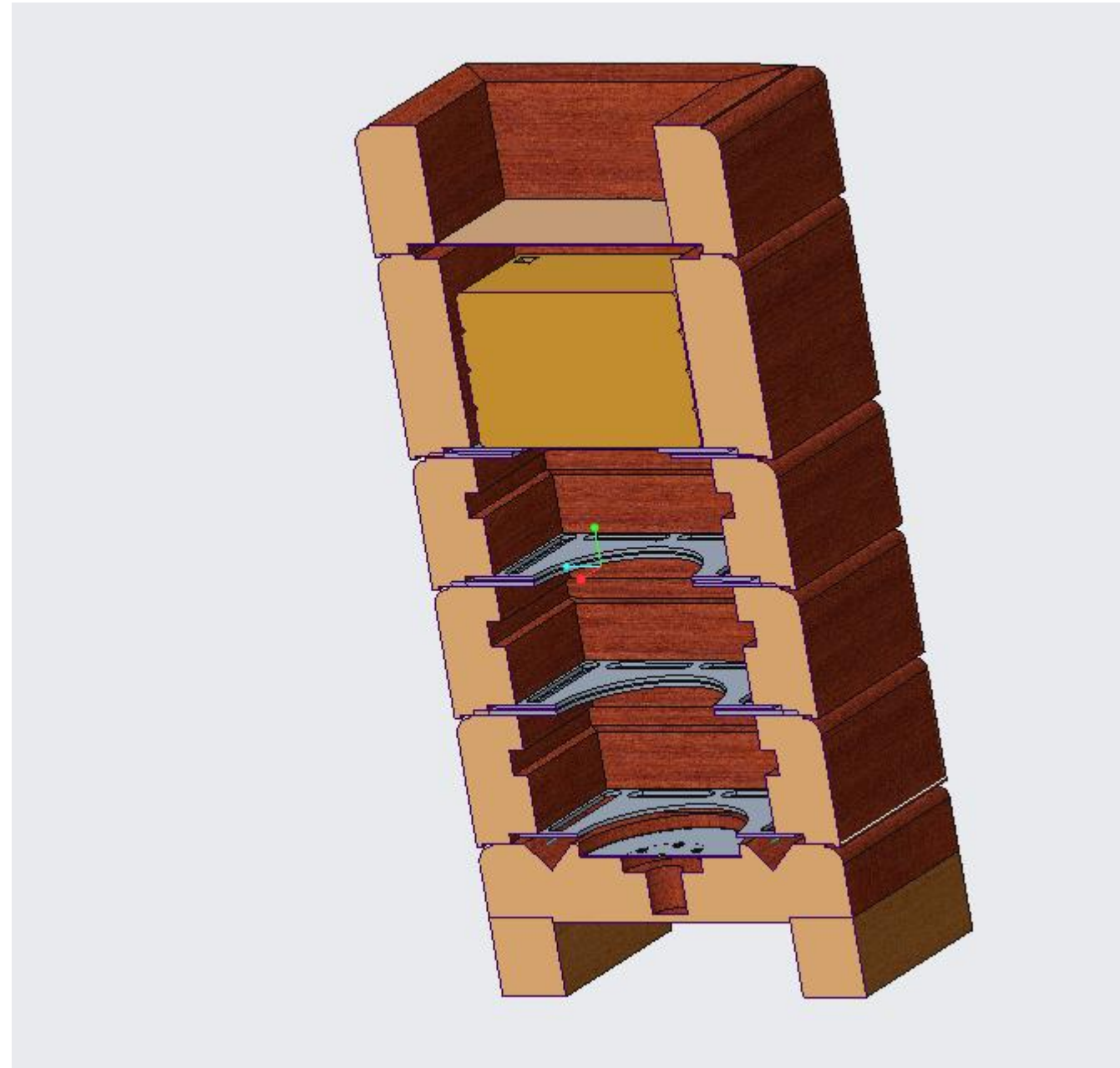

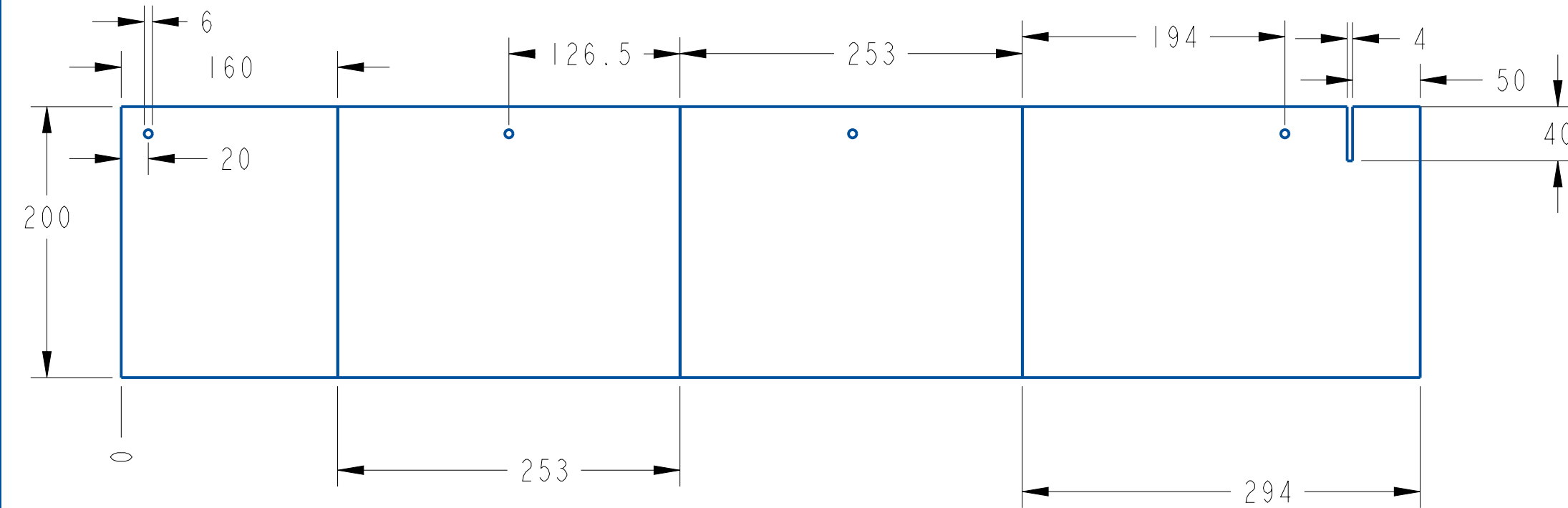

SCALE 1:4

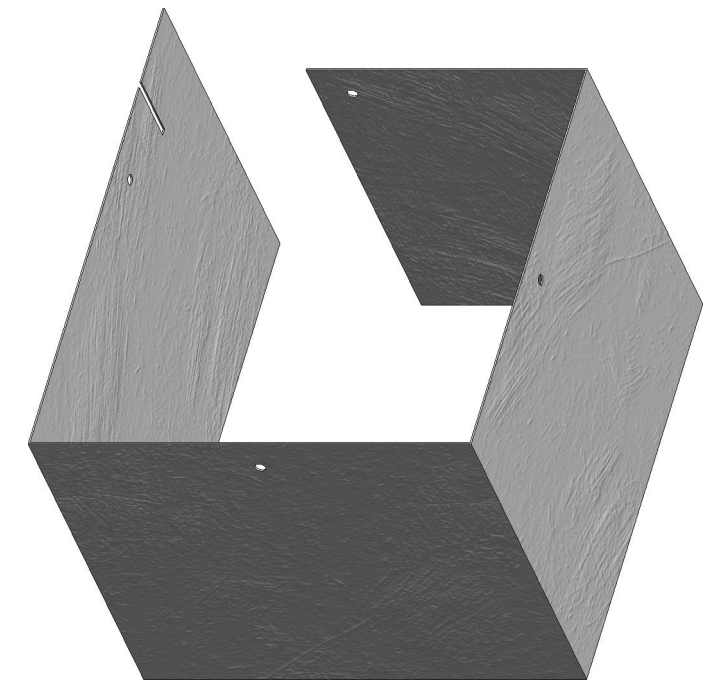

SCALE 1:4

SHROUD made from 1mm stainless steel sheet metal

This is critical and MUST be included in the build.

There is a minimum 3 degree of thermal protection with it in place.

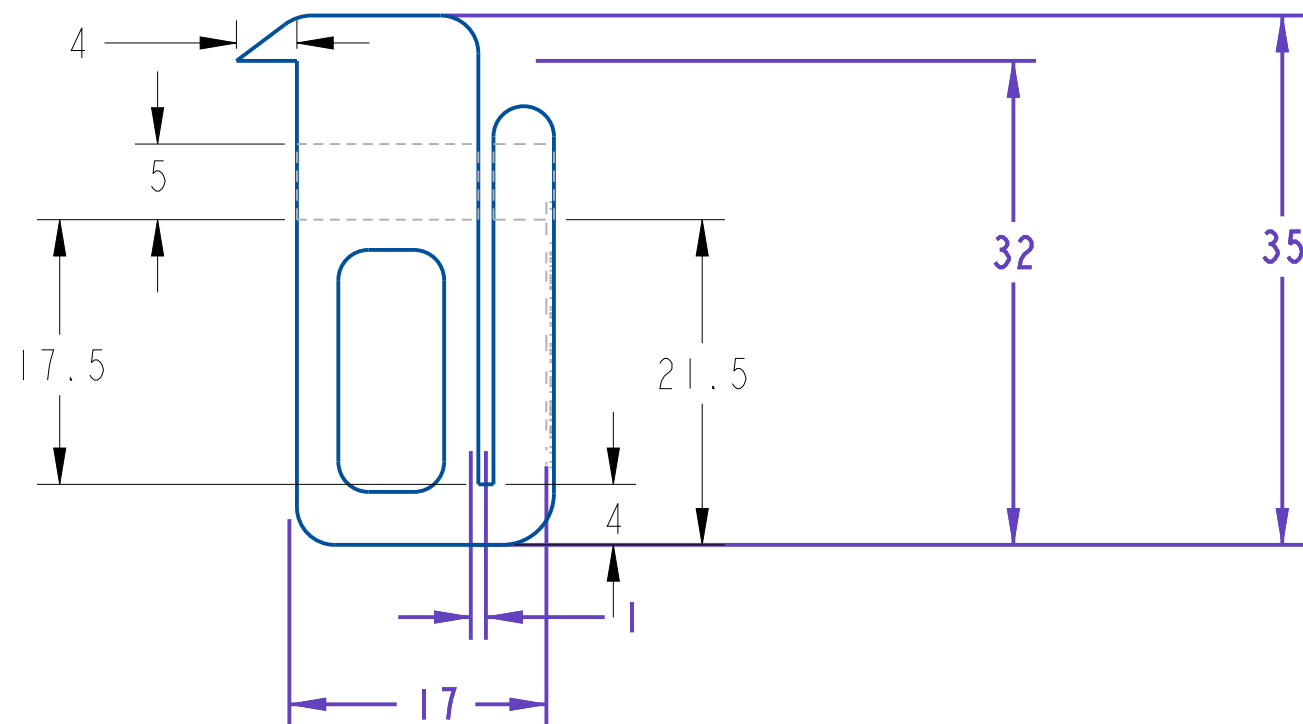

Shroud support

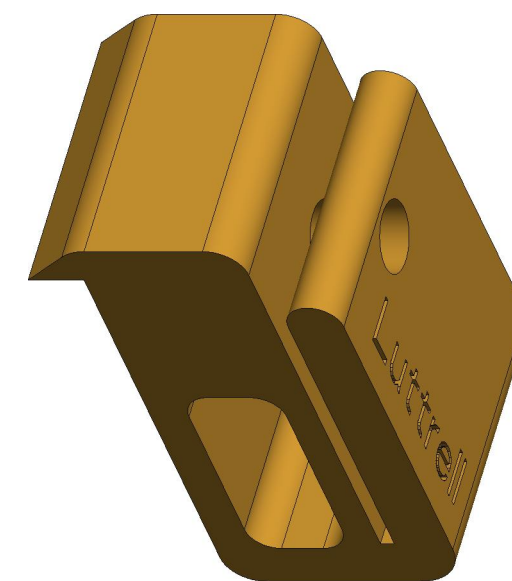

SCALE 2:1

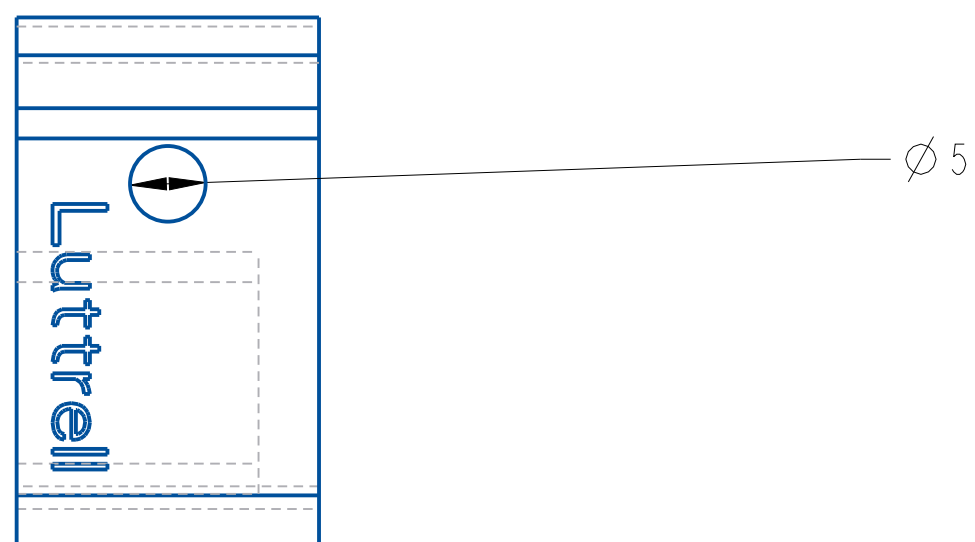

SCALE 2:1

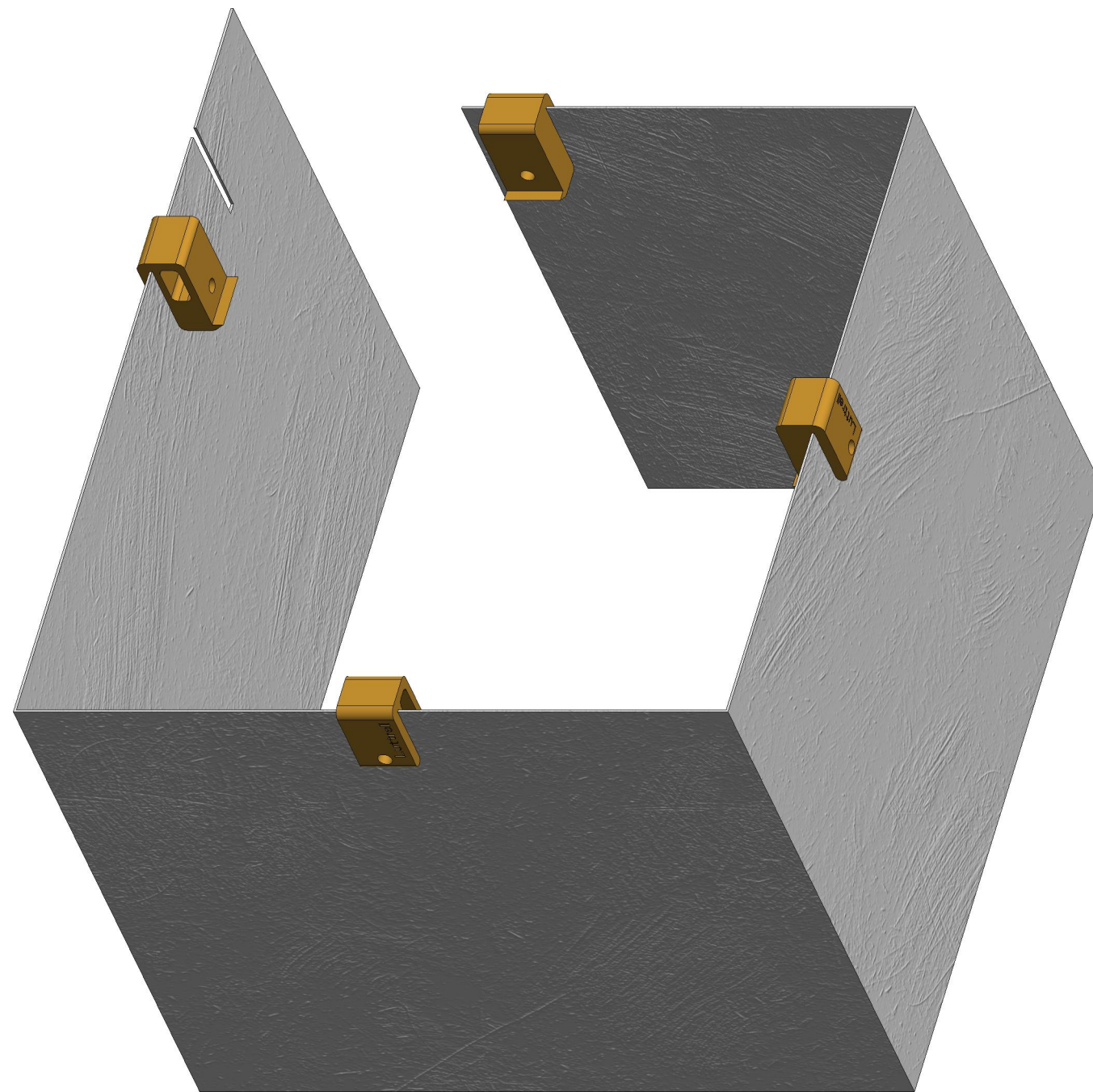

SCALE 1:2

SHROUD made from 1mm stainless steel sheet metal

This is critical and MUST be included in the build.

There is a minimum 3 degree of thermal protection with it in place.

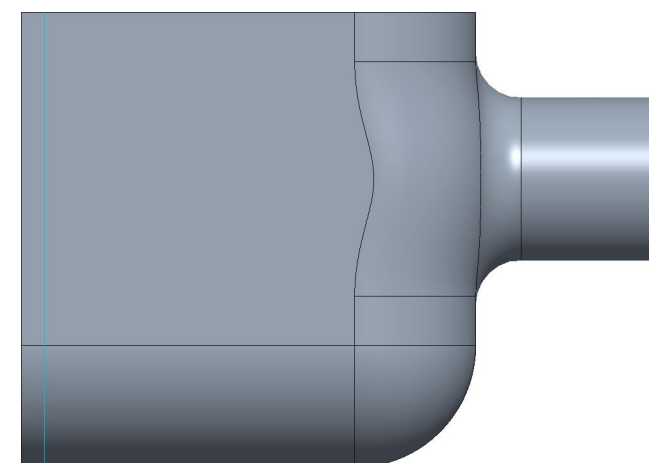
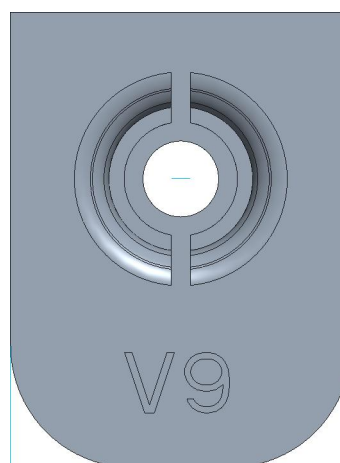
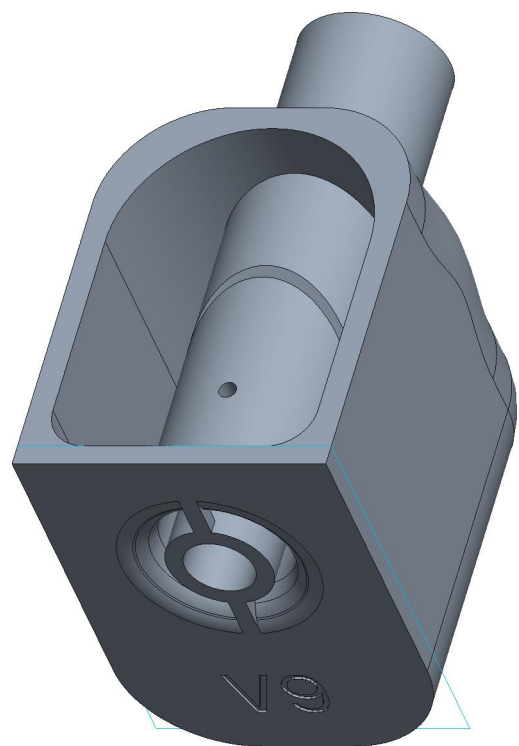

FLY Trap

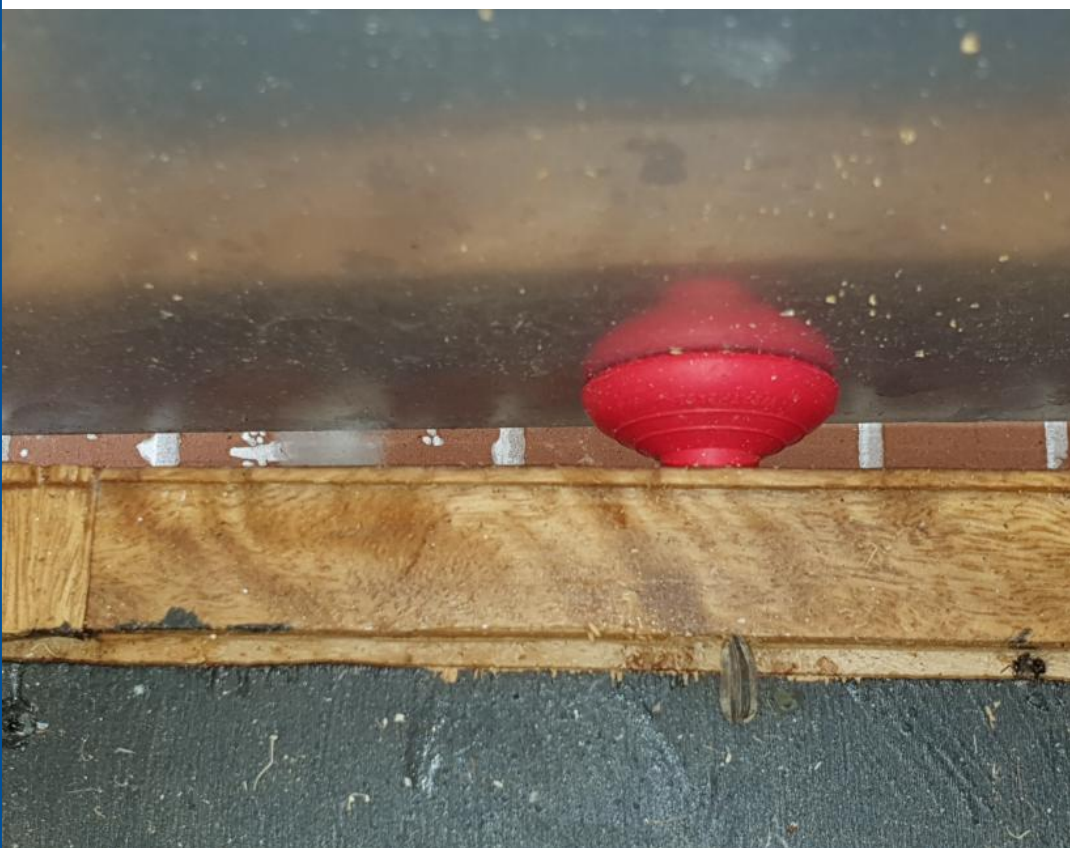





Vent with stainless steel mesh
made from 15mm pvc



Tool bits for base and entrance



Glue and clamp with adjusted string
line loop as shown and let dry before
screwing.

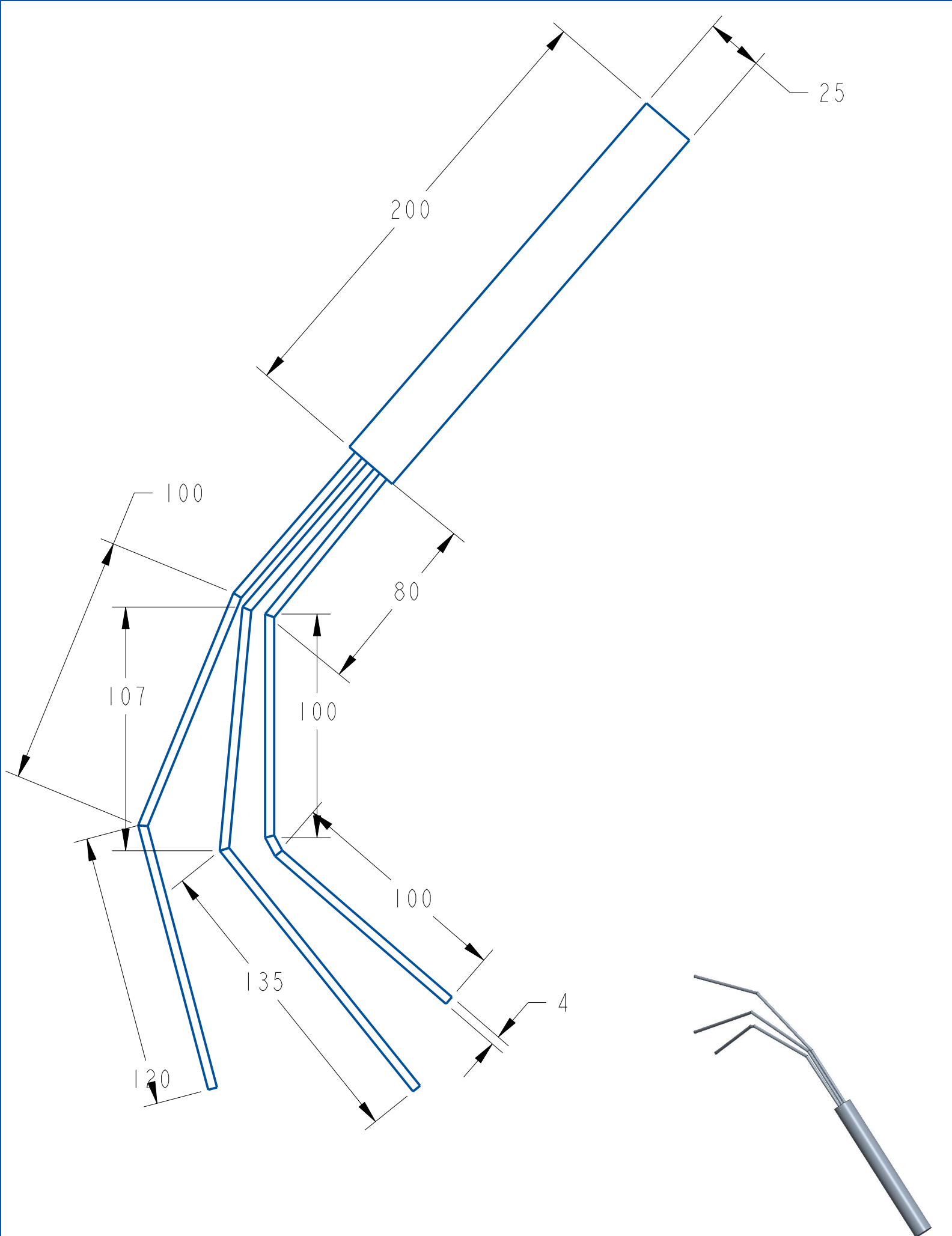

Brood manipulation tool

SCALE 1:2

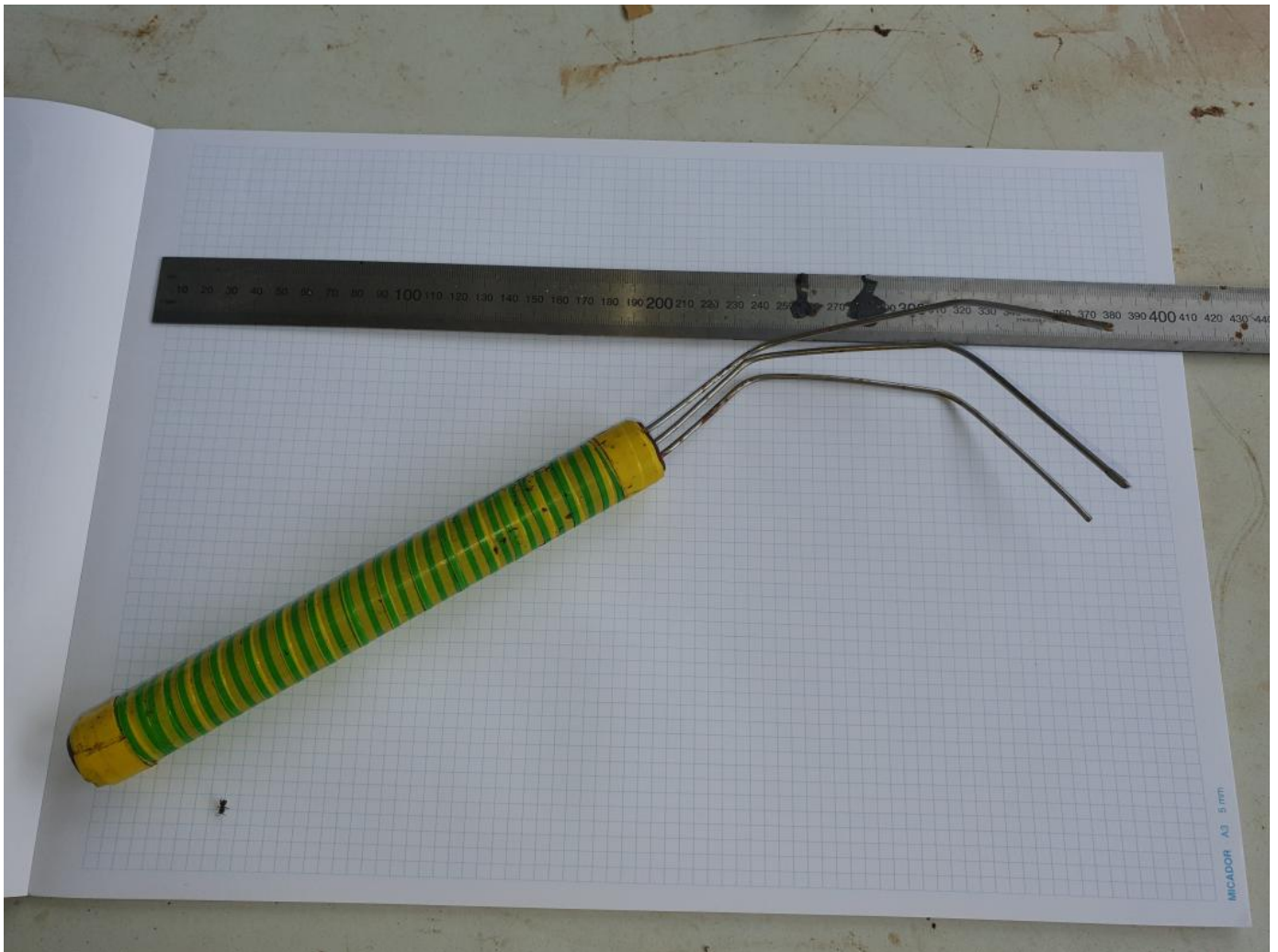

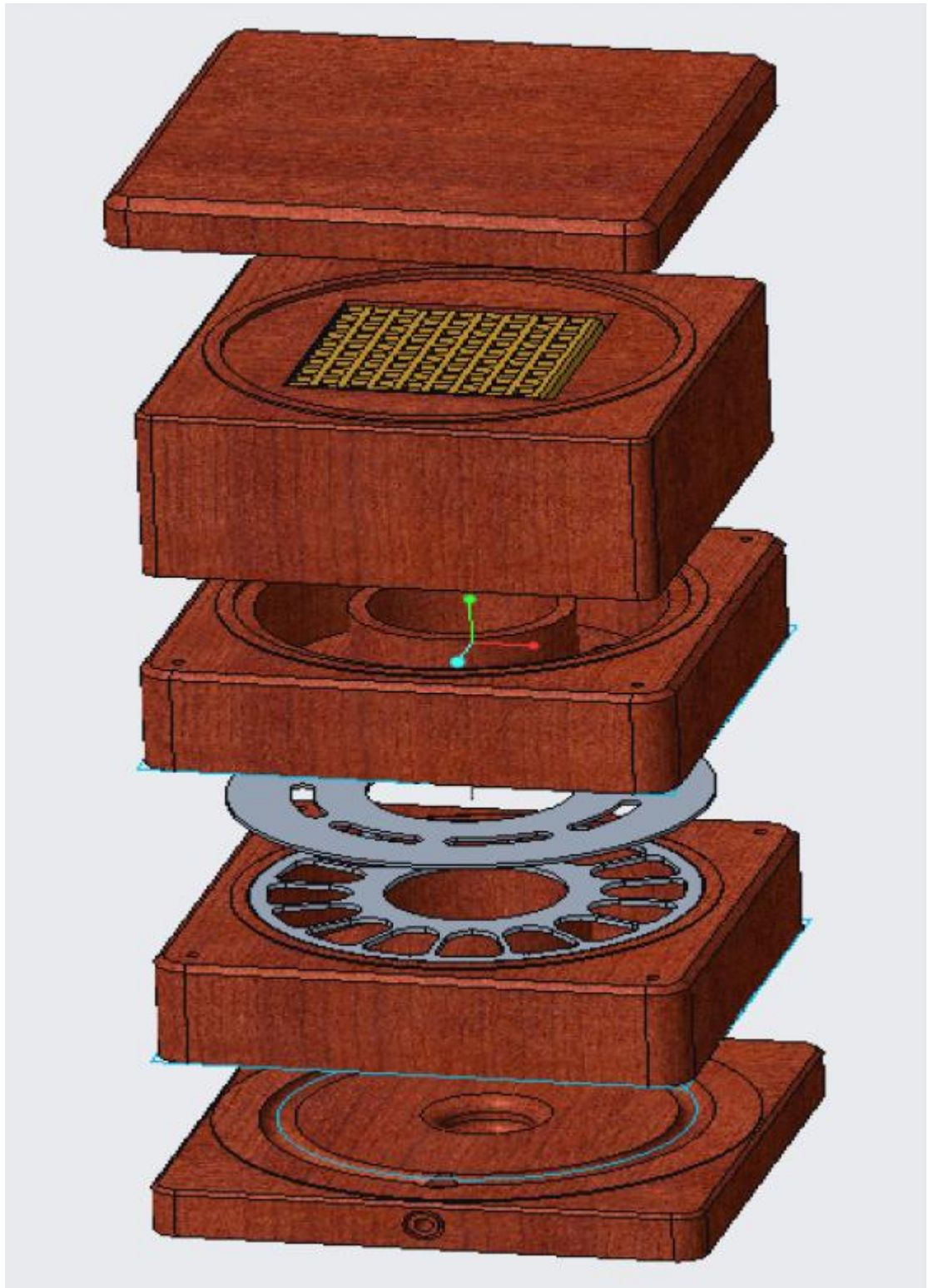

AusNOVY Hive CNC advanced configuration under development
W.Mason 4d.cnc.art@gmail.com

Three levels for TC

Four levels and a Honey super for TH

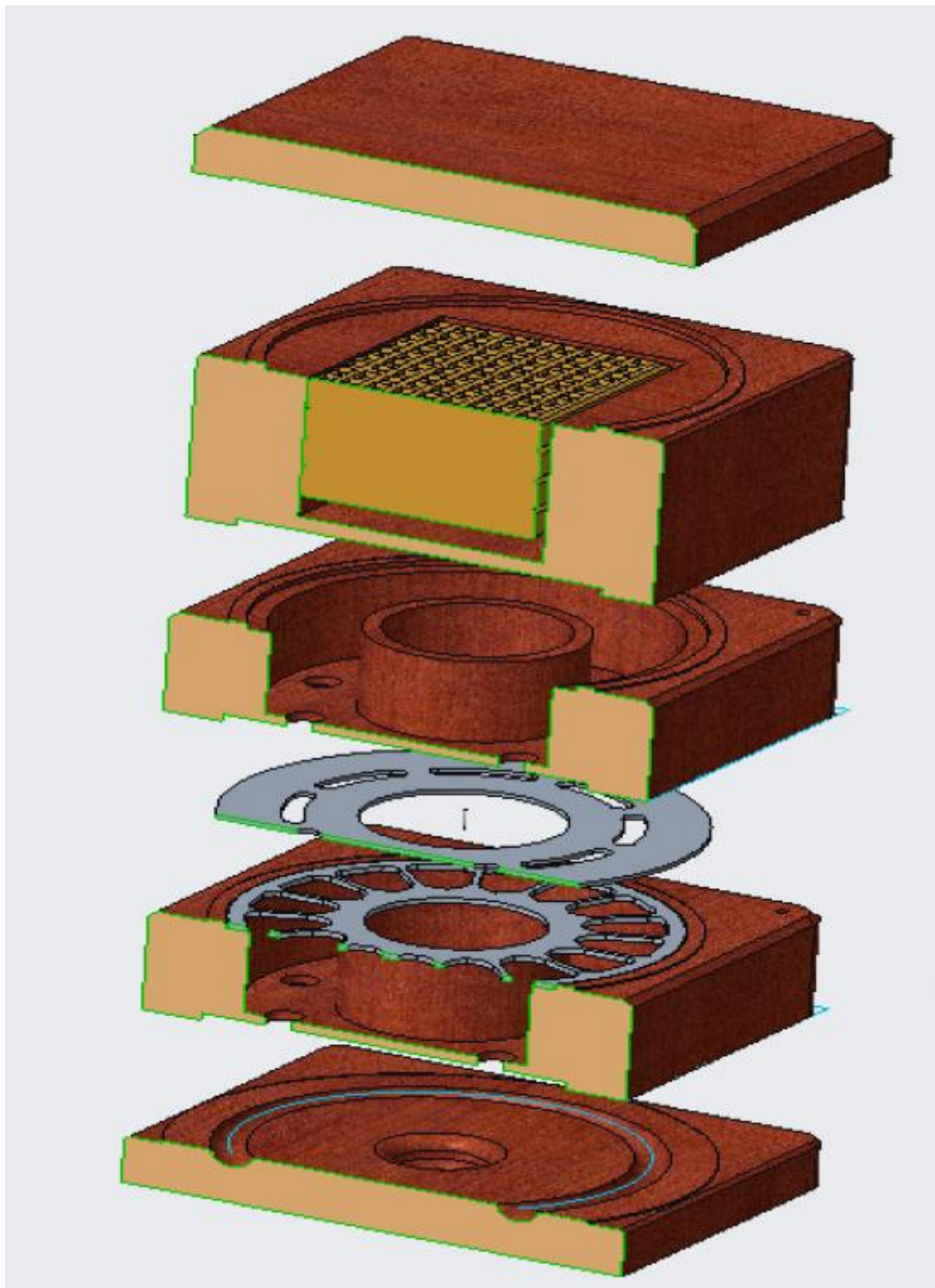

AusNOVY Hive CNC advanced configuration under development

W.Mason

4d.cnc.art@gmail.com

Three levels for TC

Four levels and a Honey super for TH

END
PAGE